

**CHICAGO FAUCETS**  
a Geberit company

2100 South Clearwater Drive  
Des Plaines, IL 60018  
Phone: 847-803-5000  
Fax: 847-803-5454  
www.chicagofaucets.com

# REPAIR PARTS

BY: JAR    DATE: 09-11-09  
CHK: *JAR*    REV:

FITTING NO.

**927-SAM**

SUBMITTED MODEL NO.

ITEM NO.

**FOR TECHNICAL ASSISTANCE**  
1-800-TEC-TRUE (1-800-832-8783)

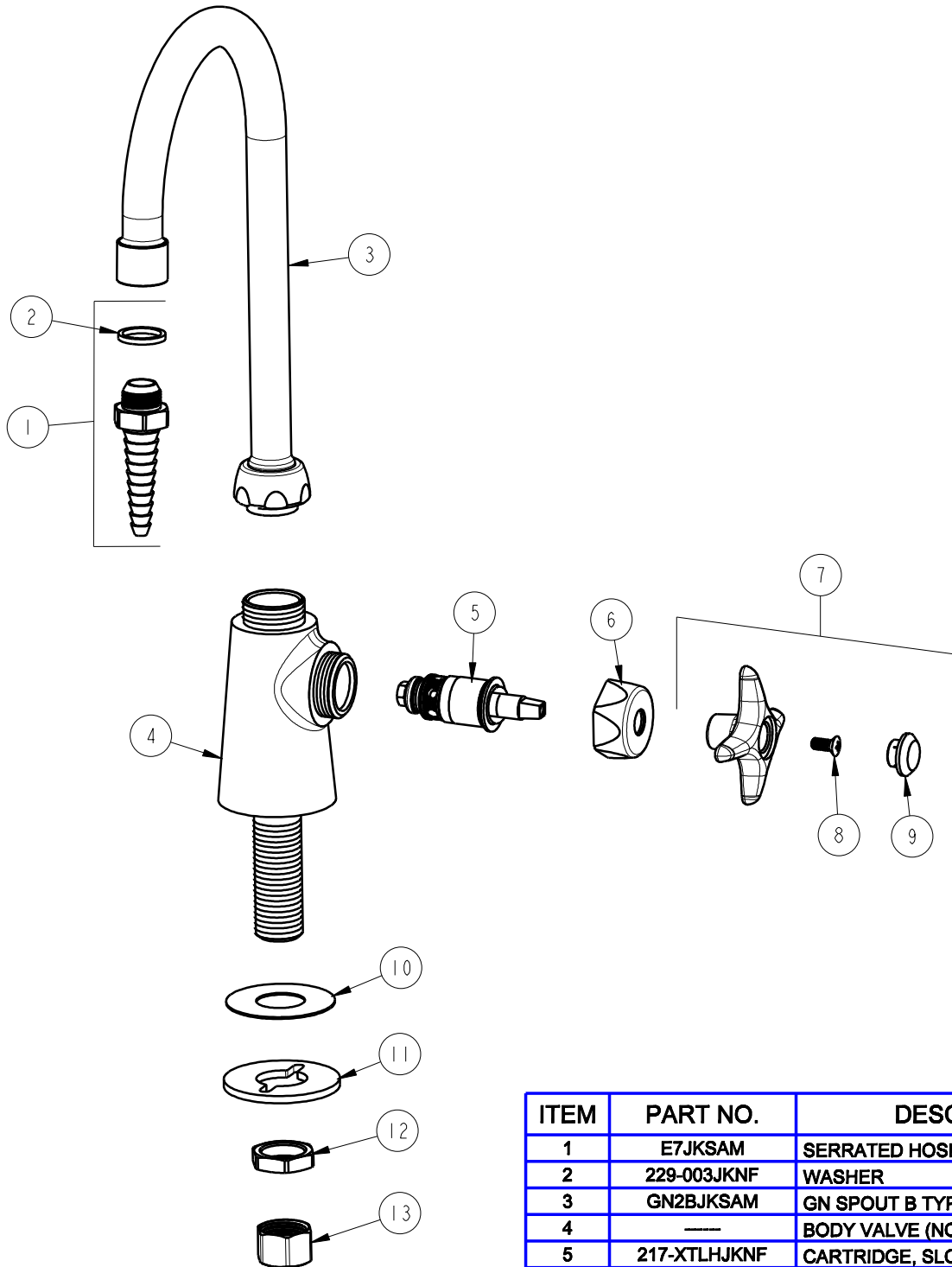

ITEM	PART NO.	DESCRIPTION
1	E7JKSAM	SERRATED HOSE NOZZLE
2	229-003JKNF	WASHER
3	GN2BJKSAM	GN SPOUT B TYPE END
4	---	BODY VALVE (NOT SOLD SEPARATELY)
5	217-XTLHJKNF	CARTRIDGE, SLO-COMPRESSION
6	444-005JKSAM	CAP
7	204-CWJKSAM	HANDLE ASSEMBLY (CW)
8	420-010JKRCF	SCREW, 10-32 UNC PH 1/2
9	216-178JKNF	BUTTON 'CW'
10	52-007JKNF	WASHER, RUBBER
11	807-112JKNF	WASHER
12	49-004JKRBF	LOCKNUT
13	49-005JKRBF	COUPLING NUT