

**CHICAGO FAUCETS**  
a Geberit company

2100 South Clearwater Drive  
Des Plaines, IL 60018  
Phone: 847-803-5000  
Fax: 847-803-5454  
www.chicagofaucets.com

**REPAIR PARTS**

FITTING NO.

**930-317XKCP**

SUBMITTED MODEL NO.

ITEM NO.

BY: SID DATE: 05-25-12

CHK: *[Signature]* REV:

**FOR TECHNICAL ASSISTANCE**  
1-800-TEC-TRUE (1-800-832-8783)

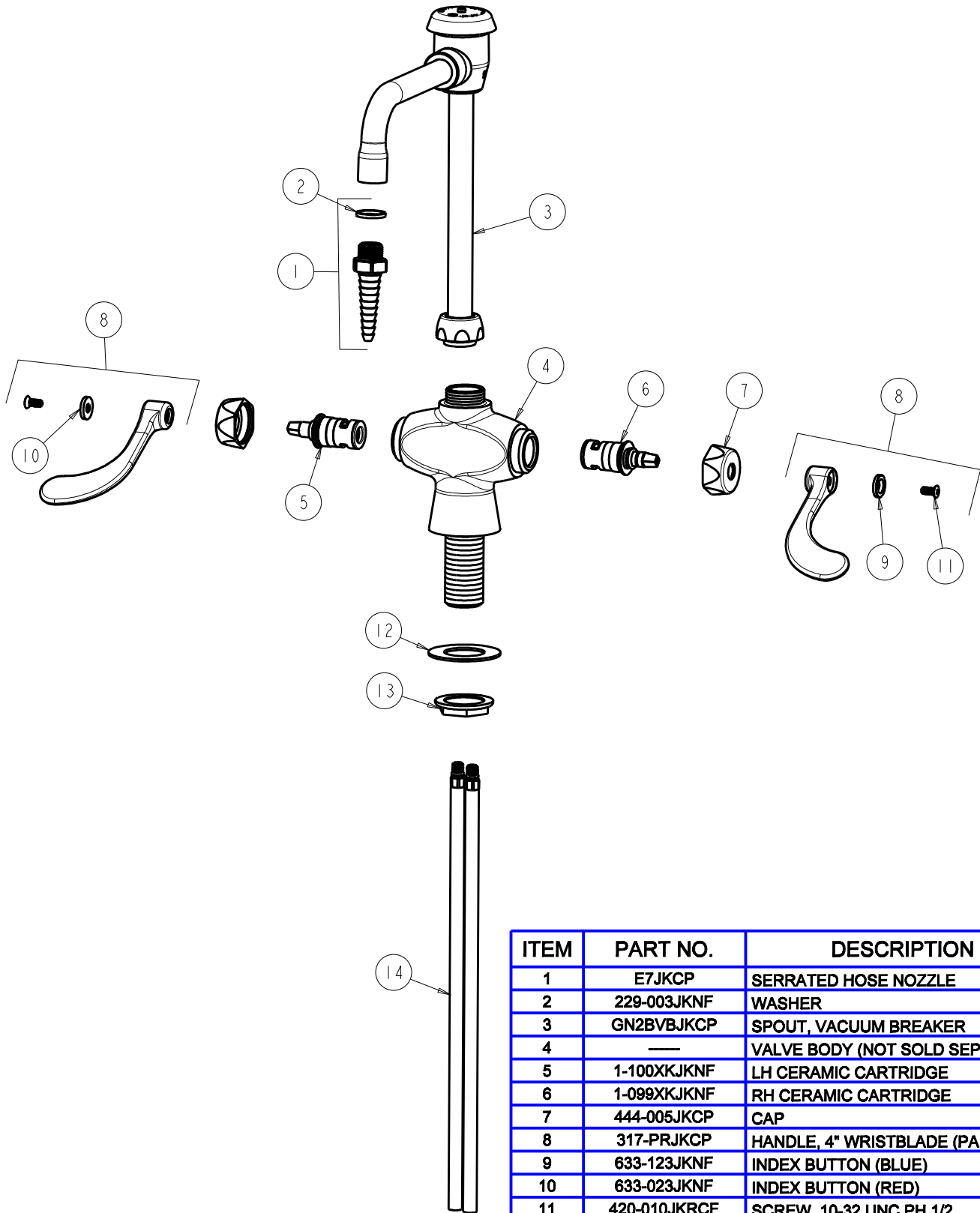

ITEM	PART NO.	DESCRIPTION
1	E7JKCP	SERRATED HOSE NOZZLE
2	229-003JKNF	WASHER
3	GN2BVBJKCP	SPOUT, VACUUM BREAKER
4	—	VALVE BODY (NOT SOLD SEPARATELY)
5	1-100XKJKNF	LH CERAMIC CARTRIDGE
6	1-099XKJKNF	RH CERAMIC CARTRIDGE
7	444-005JKCP	CAP
8	317-PRJKCP	HANDLE, 4" WRISTBLADE (PAIR)
9	633-123JKNF	INDEX BUTTON (BLUE)
10	633-023JKNF	INDEX BUTTON (RED)
11	420-010JKRCF	SCREW, 10-32 UNC PH 1/2
12	50-014JKNF	STEEL WASHER
13	50-003JKRBF	LOCKNUT
14	50-101KJKNF	SUPPLY TUBE ASSEMBLY