

SIMPSON

Dura-Vent

Applications

DuraLiner is a high-temperature, double-wall, masonry relining system for use with appliances fueled by gas, pellet, oil, wood, or coal. It safely protects masonry chimneys from the damaging effects of flue product condensation.

Materials and Construction

.016" 304 stainless steel inner liner. Rigid relining pipe: double-walled with 304 stainless steel inner and galvalume outer. Factory-insulated with a 0.5" insulation blanket. DuraLiner Rigid Pipe in round or oval, is constructed with built-in fittings and pre-drilled holes (stainless steel rivets included).

Clearances

Rigid double wall: 0" clearance between the liner and masonry and 0" clearance between the masonry and combustibles. DuraLiner Flex: 1" clearance to masonry. Zero clearance with sleeve.

Diameters

6" and 8".

Listings

UL Listed to UL1777 (MH14420), ULC Listed to ULC-S635 and ULC-S640 (CMH1329)

Limited-Lifetime Warranty



DuraLiner

DuraLiner ensures safe and efficient venting of heating appliances, while protecting the masonry chimney from the damaging effects of flue product condensation. It is the only factory-insulated product with zero/zero clearance for high heat wood-burning appliances. No need to uncoil flex, insulate a majority of the pipe, or protect the insulation when installing. A smooth inner means less creosote buildup.

Installers reduce labor time by 50% or more with DuraLiner. No time wasted wrapping insulation around liner for UL1777 approval. No warping or ovalizing. No investment needed in special equipment or tools or cutting pieces on the job site.

No spacers needed to maintain clearance in tight offsets or dampers. Approved for use in both the USA and Canada.



Typical Installations

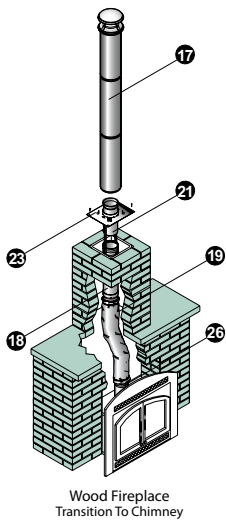
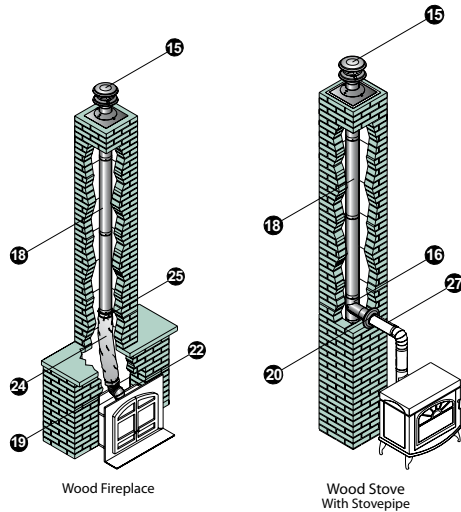

Installation Key			
15	Extend-A-Cap Kit	22	30° or 45° SS Elbow
16	Round Tee with Round Branch	23	Transition Anchor Plate
17	DuraTech or DuraPlus Chimney	24	Two-Ply Insulation Sleeve
18	DuraLiner - rigid length	25	Insulation Clamp
19	DuraLiner - flexible length	26	DuraLiner Appliance Connector
20	Masonry Thimble w/ Slip Connector	27	DVL or DuraBlack Stovepipe
21	Slip Connector and Hanger		

- Refer to our Typical Venting Installation drawings to select the appropriate component parts for your installation.
- The inner pipe diameter should match the outlet size of the appliance.
- Check the appliance manufacturer's installation instructions for any venting restrictions.
- Be fire-safe! Maintain at least the minimum clearances (air-space) between the vent pipe and nearby combustibles, as specified in the appliance manufacturer's installation instructions. Use proper support and bracing. Follow local building codes and have your venting system inspected.

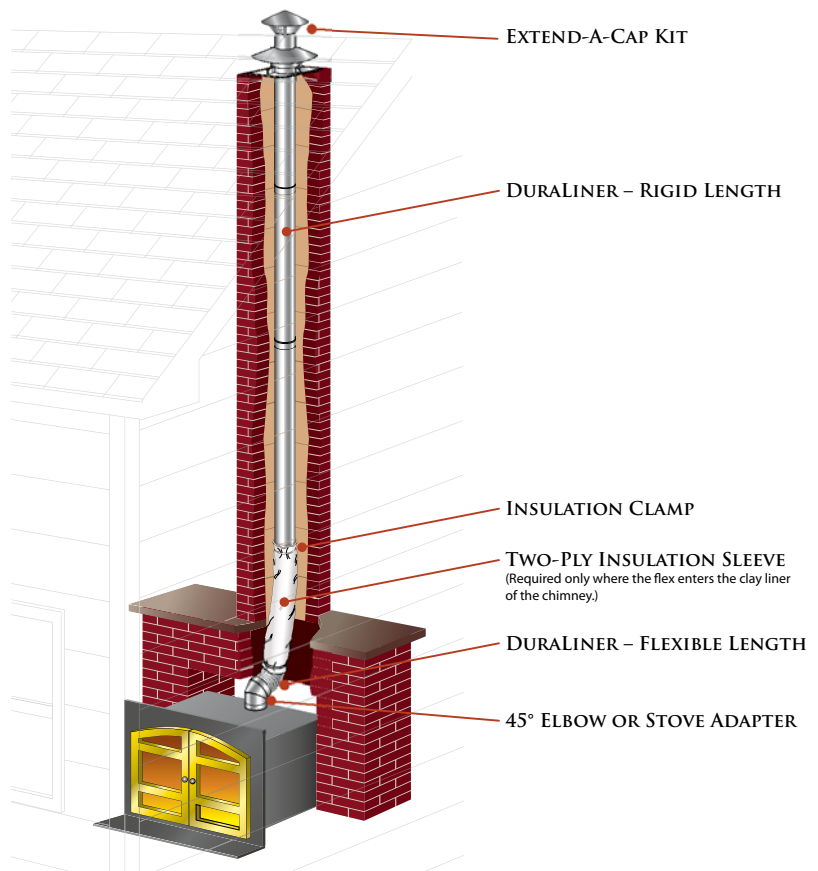

Planning Your Installation

1	Verify the venting requirements of the appliance used. Choose the liner system appropriate for the appliance and installation.
2	Refer to the Typical Installations for the needed parts for installation.
3	The size of the liner should match the outlet size on the appliance or the size of the vent/manifold that penetrates into the masonry chimney.
4	Determine the length of liner needed. When using DuraLiner, subtract 1 ½" overlap per joint.
5	Make sure the top of the masonry chimney has a leveled surface to insure a proper fit for the Extend-A-Cap and provide a secure, leak-proof installation.
6	If a free-standing appliance is used, select the vent or stovepipe pieces to connect from the appliance to the liner (refer to the appropriate Simpson Dura-Vent catalog).
7	For Installations using a Transition Anchor Plate, refer to the DuraTech, DuraPlus or DuraPlus HTC catalogs or installation instructions for proper parts and installation.
8	Important! Check to be sure the installation complies with all local and national code requirements, including clearance to combustibles. Contact the local building inspector for permit requirements.

How Size and Height Affect Stove Performance

The following design recommendations are intended only as a general guideline to assist in the design and selection of liner components for your installation. Read and follow the DuraLiner installation instructions before installation begins.

Before relining a chimney, it should be cleaned and inspected to verify the integrity of the mortar and masonry. This is an important fire safety issue that may have an influence on how the liner is installed. DuraLiner is approved for 0" clearance between the liner and masonry and 0" clearance between the masonry and combustibles.

DuraLiner is used for wood-burning appliances when zero clearance or oval pipe is needed.

Refer to the appliance manufacturer for installation requirements affecting venting. Keep the vent path as straight as possible for best performance.

Restore Deteriorating Chimneys with DuraLiner

When a masonry chimney is damaged or has fallen down, it can be replaced with a safe, factory-built chimney. DuraLiner, when used with a Transition Anchor Plate and in combination with DuraTech, DuraPlus, or DuraPlus HTC Chimneys, replaces the damaged masonry chimney with a safe, efficient, and economical chimney that is UL Listed (DuraPlus HTC is listed for use in Canada). See Typical Installations for details.

30° Stove Connector

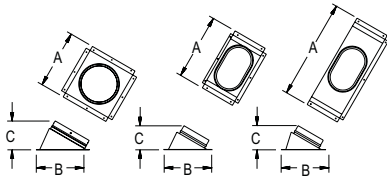

Connects stove outlets to round or oval DuraLiner pipe at a 30° angle.

SIZE	CONNECTION	STOCK #	A	B	C
6"	Round - Round	4681	8 1/8"	9 3/4"	5 3/8"
6"	Round - Oval	4681-RO	9 3/8"	7 3/4"	5 7/8"
6"	Oval - Oval	4681-0	15"	7 3/8"	4"
8"	Round-Round	4881	10"	11 5/8"	6 1/4"
8"	Round - Oval	4881-RO	12 1/4"	9 3/4"	5 7/8"
8"	Oval - Oval	4881-0	15"	7 3/8"	4"

Flat Stove Connector

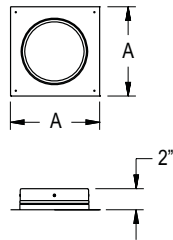

Connects stove outlets to round or oval DuraLiner pipe. Oval stove connector is sized to easily convert round stove outlets to oval DuraLiner pipe.

SIZE	STOCK #	A
6" ROUND	4680	10 1/4"
6" OVAL	4680-0	--
8" ROUND	4880	12 1/4"
8" OVAL	4880-0	--

30° and 45° Stainless Steel Elbows

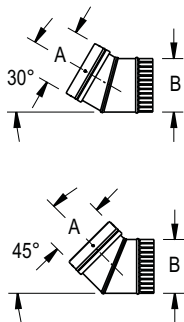

Use as a stove connector to DuraLiner. Features built-in fittings for easy connection to DuraLiner. 30° and 45° elbows are single-wall.

SIZE	ANGLE	STOCK #	A	B
6"	30°	4630	6 1/2"	6"
6"	45°	4645	6 1/2"	6"
8"	30°	4830	8 1/2"	8"
8"	45°	4845	8 1/2"	8"

Round Tee With Round Branch With Cap

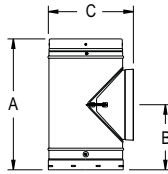

Provides connection between Masonry Wall Thimble or stove connector pipe to round DuraLiner.

SIZE	STOCK #	A	B	C
6"	4667	15 1/8"	7 1/2"	8"
8"	4867	15 1/8"	7 1/2"	10"

Oval Tee With Round Branch With Cap

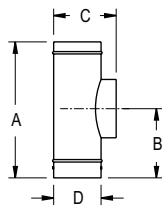

Provides connection between Masonry Wall Thimble or stove connector pipe to oval DuraLiner. Single-wall. May require additional insulation. Refer to DuraLiner installation instructions.

SIZE	STOCK #	A	B	C	D
6"	4667-0	14 1/4"	7 1/2"	6 7/16"	4 7/8"
8"	4867-0	14 1/4"	7 1/2"	6 7/16"	4 7/8"

Spacer

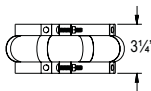

Use to maintain a 1" clearance with flex sections of DuraLiner.

SIZE	STOCK #
6" OVAL	4668-0
8" OVAL	4868-0

Adjustable Sleeve

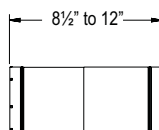

Used for rear stove exits; must be purchased separately. Sleeve adjusts from 8 1/2" to 12"

SIZE	STOCK #
6"	4666
8"	4866

Masonry Thimble with Slip Connector

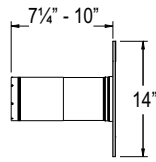

Penetrates masonry chimney to allow connection of DuraBlack pipe or DVL black pipe to DuraLiner.

SIZE	STOCK #
6"	4666
8"	4866

Wall Pass Through

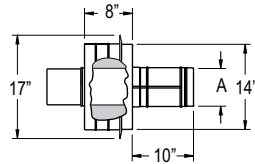

Connects to a DuraLiner tee to bring DuraLiner through a masonry chimney and a combustible wall. Allows the connection of DuraBlack pipe or when used with the appropriate adapter. DVL black pipe will connect directly to the Wall Pass Through.

SIZE	STOCK #	A
6"	4644	6 1/2"
8"	4844	8 1/2"

Round-To-Round Heavy Duty Flex Pipe

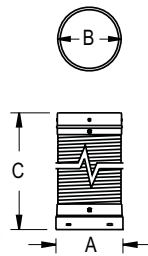

Round-to-Round Flex pipe built from .016", 304 stainless steel, 4-ply construction. Use through damper and smoke shelf area. Features built-in fittings, which eliminates field cutting and fitting. Use with DuraLiner Two-Ply Insulation Sleeve for zero clearance applications where flex extends into clay liner.

SIZE	STOCK #	A	B	C
6"	6DL-360F	7 3/4"	7 1/2"	36"
6"	6DL-600F	7 3/4"	7 1/2"	60"
8"	8DL-360F	10 3/4"	10 1/2"	36"
8"	8DL-600F	10 3/4"	10 1/2"	60"

Round-To-Round Flex Pipe

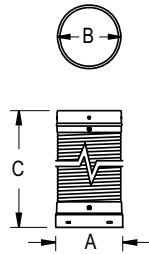

Use through damper and smoke shelf area. Built from 304 stainless steel. Use with DuraLiner Two-Ply Insulation Sleeve for zero clearance applications where flex extends into clay liner.

SIZE	STOCK #	A	B	C
6"	4636-F	6 5/8"	6 1/2"	36"
6"	4660-F	6 5/8"	6 1/2"	60"
8"	4836-F	8 5/8"	8 1/2"	36"
8"	4860-F	8 5/8"	8 1/2"	60"

Oval-To-Oval Heavy Duty Flex Pipe

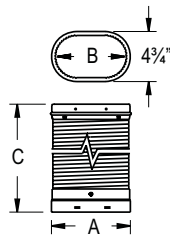

Oval-to-Oval Flex pipe built from .016", 304 stainless steel, 4-ply construction. Use through damper and smoke shelf area. Features built-in fittings, which eliminates field cutting and fitting. Use with DuraLiner Two-Ply Insulation Sleeve for zero clearance applications where flex extends into clay liner.

SIZE	STOCK #	A	B	C
6"	6DL-360F	7 3/4"	7 1/2"	36"
6"	6DL-600F	7 3/4"	7 1/2"	60"
8"	8DL-360F	10 3/4"	10 1/2"	36"
8"	8DL-600F	10 3/4"	10 1/2"	60"

Oval-To-Oval Flex Pipe

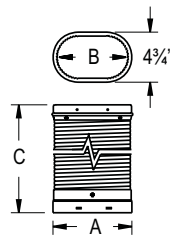

Use through damper and smoke shelf area. Built from 304 stainless steel. Use with DuraLiner Two-Ply Insulation Sleeve for zero clearance applications where flex extends into clay liner.

SIZE	STOCK #	A	B	C
6"	4636-0F	7 3/4"	7 1/2"	36"
6"	4660-0F	7 3/4"	7 1/2"	60"
8"	4836-0F	10 3/4"	10 1/2"	36"
8"	4860-0F	10 3/4"	10 1/2"	60"

Oval-To-Round Heavy Duty Flex Pipe



Oval-to-Round flex pipe built from .016", 304 stainless steel, 4-ply construction. Use through damper and smoke shelf area. Use to connect from oval stove outlet to round DuraLiner. Use with DuraLiner Two-Ply insulation Sleeve for zero clearance applications where flex extends into clay liner.

SIZE	STOCK #	A	B	C
6"	6DL-360RF	7 3/4"	6 1/2"	36"
6"	6DL-600RF	7 3/4"	6 1/2"	60"
8"	8DL-360RF	10 3/4"	8 1/2"	36"
8"	8DL-600RF	10 3/4"	8 1/2"	60"

Oval-To-Round Flex Pipe

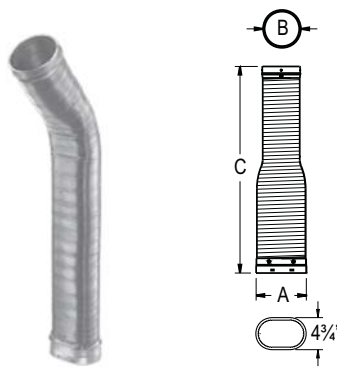

Use through damper and smoke shelf area. Use to connect from oval stove outlet to round DuraLiner. Built from 304 stainless steel. Use with DuraLiner Two-Ply insulation Sleeve for zero clearance applications where flex extends into clay liner.

SIZE	STOCK #	A	B	C
6"	4636-OR	7 3/4"	6 1/2"	36"
6"	4660-OR	7 3/4"	6 1/2"	60"
8"	4836-OR	10 3/4"	8 1/2"	36"
8"	4860-OR	10 3/4"	8 1/2"	60"

Round-To-Oval Flex Pipe

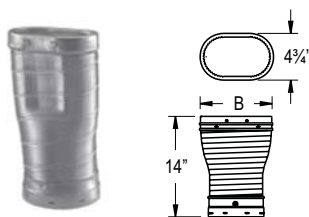

Use as a stove connector from a round stove outlet to oval DuraLiner. Built from 304 stainless steel. Use with DuraLiner Two-Ply insulation Sleeve for zero clearance applications where flex extends into clay liner.

SIZE	STOCK #	A	B
6"	4614-RO	6 1/2"	7 3/4"
8"	4814-RO	8 1/2"	10 3/4"

Round Rigid Pipe

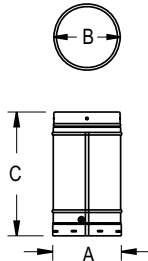

Available in 6" and 8" diameters in 12", 24", 36", and 48" lengths. Factory insulated. Built-in, pre-drilled fittings for riveting joints. UL Listed for zero clearance between masonry and combustibles, plus zero clearance between liner and masonry. 304 stainless steel inner and aluminized steel outer.

SIZE	STOCK #	A	B	C
6"	4612	6 5/8"	6 1/2"	12"
6"	4624	6 5/8"	6 1/2"	24"
6"	4636	6 5/8"	6 1/2"	36"
6"	4648	6 5/8"	6 1/2"	48"
8"	4812	8 5/8"	8 1/2"	12"
8"	4824	8 5/8"	8 1/2"	24"
8"	4836	8 5/8"	8 1/2"	36"
8"	4848	8 5/8"	8 1/2"	48"

Oval Rigid Pipe

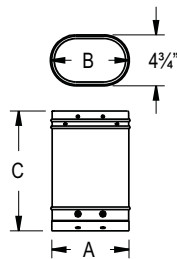

Factory insulated, Oval Rigid Pipe is available in 6" and 8" diameters; 12", 24", 36", and 48" lengths. Insulated. Built-in pre drilled fittings for riveting joints. UL Listed for zero clearance between masonry and combustibles, plus zero clearance between liner and masonry. 304 stainless steel inner and aluminized steel outer.

SIZE	STOCK #	A	B	C
6"	4612-OP	7 3/4"	7 1/2"	12"
6"	4624-OP	7 3/4"	7 1/2"	24"
6"	4636-OP	7 3/4"	7 1/2"	36"
6"	4648-OP	7 3/4"	7 1/2"	48"
8"	4812-OP	10 3/4"	10 1/2"	12"
8"	4824-OP	10 3/4"	10 1/2"	24"
8"	4836-OP	10 3/4"	10 1/2"	36"
8"	4848-OP	10 3/4"	10 1/2"	48"

Extend-A-Cap Kit

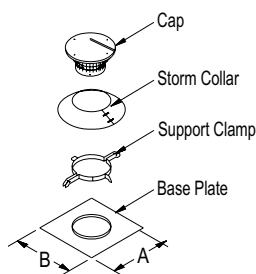

Terminates DuraLiner at the top of the masonry chimney. Kit includes Base Plate, Support Clamp, Storm Collar, and Cap (with spark arrestor). Pipe not included.

SIZE	STOCK #	A	B
6"	4685	13"	13"
6"	4686	13"	18"
6"	4688-0	13"	20"
6"	4687-0	10"	22"
8"	4885	13"	13"
8"	4886	13"	18"
8"	4886-0	13"	20"
8"	4885-0	10"	22"

Slip Connector and Hanger



Use with Transition Anchor Plate to transition from DuraLiner to DuraTech, DuraPlus, or DuraPlus HTC chimney. 14" Slip Connector.

SIZE	STOCK #
6"	4671
8"	4871

Transition Anchor Plate

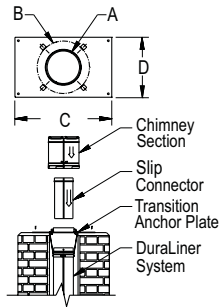

Use with Slip Connector and Hanger in chimney restoration to connect DuraLiner pipe to DuraTech, DuraPlus, or DuraPlus HTC Chimney.

DURAPLUS HTC					
SIZE	STOCK #	A	B	C	D
6"	9040A	6 1/16"	10 3/8"	17"	14"
6"	9040B	6 1/16"	10 3/8"	17"	17"
6"	9040C	6 1/16"	10 3/8"	21"	13"
6"	9040D	6 1/16"	10 3/8"	21"	17"
8"	9240A	8 1/16"	12 3/8"	17"	14"
8"	9240B	8 1/16"	12 3/8"	17"	17"
8"	9240C	8 1/16"	12 3/8"	21"	13"
8"	9240D	8 1/16"	12 3/8"	21"	17"
DURATECH					
SIZE	STOCK #	A	B	C	D
6"	9440A	6 1/16"	8 3/16"	17"	14"
6"	9440B	6 1/16"	8 3/16"	17"	17"
6"	9440C	6 1/16"	8 3/16"	21"	13"
6"	9440D	6 1/16"	8 3/16"	21"	17"
8"	9640A	8 1/16"	10 3/16"	17"	14"
8"	9640B	8 1/16"	10 3/16"	17"	17"
8"	9640C	8 1/16"	10 3/16"	21"	13"
8"	9640D	8 1/16"	10 3/16"	21"	17"

Two-Ply Insulation Sleeve



Use with DuraLiner round and oval flex lengths above the first clay flue tile to meet UL 1777 standards. (Use to meet zero-clearance requirements between the DuraLiner length and the inside of the chimney, and, the outside combustibles above the first clay flue tile.) Features high-temperature blanket insulation with an abrasion resistant fabric cover. Use with Insulation Clamp (below).

SIZE	STOCK #
5"-6"	7102-ZC
7"-8"	7104-ZC

Insulation Clamp



Fits round or oval up to 8". Universal No bolt or steel protrusions minimizes snagging. Toggle action provides fast, secure fit.

SIZE	STOCK #
Universal	4910