



# ENGINEERING EXCELLENCE

Premium Series #2PM540

PARTS BREAKDOWN SHEET

### DESCRIPTION

- Two Handle Wall Mount Faucet
- Metal Cross Handles
- Tubular Spout
- 10-1/2" Reach
- Ceramic Disc Cartridges
- 2-Hole 3-1/2" to 8-1/2" Installation
- 1/2" Eccentric Connections

### FINISHES

- PC PVD Polished Chrome
- BN PVD Brushed Nickel



#2PM540 SHOWN

### STANDARDS APPLICABLE

- ASME A112.18.1
- ANSI / NSF 61, SECTION 9
- CUPC / IAPMO LISTED
- CONTAINS NO MORE THAN 0.25% WEIGHTED AVERAGE LEAD CONTENT

### FLOW

- Aerator Limited to 1.5 gpm

Model #: \_\_\_\_\_

Specific Features: \_\_\_\_\_

Project Name: \_\_\_\_\_

Submitted For: \_\_\_\_\_

Model	Description	Finishes	
#2PM540	Two Handle Wall Mount Faucet	<input type="checkbox"/> PC	<input type="checkbox"/> Other__



ENGINEERING EXCELLENCE

Pioneer:1-800-338-9468  
 Commerce, CA 90040  
 www.pioneerind.com  
 Pioneer Industries, Inc. © 2013

DMPB2PM540/REV. 12 2012  
 Page 1 of 2

	ITEM#	DESCRIPTION
A	X-120005C,H*	Premium Cross Handle - Cold, Hot
B	X-4200054*	Handle Bonnet Nut
C	X-3200003	Premium Ceramic Stem
D	X-4200056*	Eccentric Elbow
E	X-4200057*	Flange
F	X-2200009*	Premium Tubular Spout
1	X-4200055C,H*	Index Button - Cold, Hot
2	X-4900029	Screw
3	X-4900030	Washer
4	X-4200120*	1.5 GPM Aerator
5	X-4200053*	Spout Bonnet Nut
6	X-4200090	Spout Snap Ring
7	X-4900012	Spout O-Ring

\* Note- Please specify finish/color code while ordering.

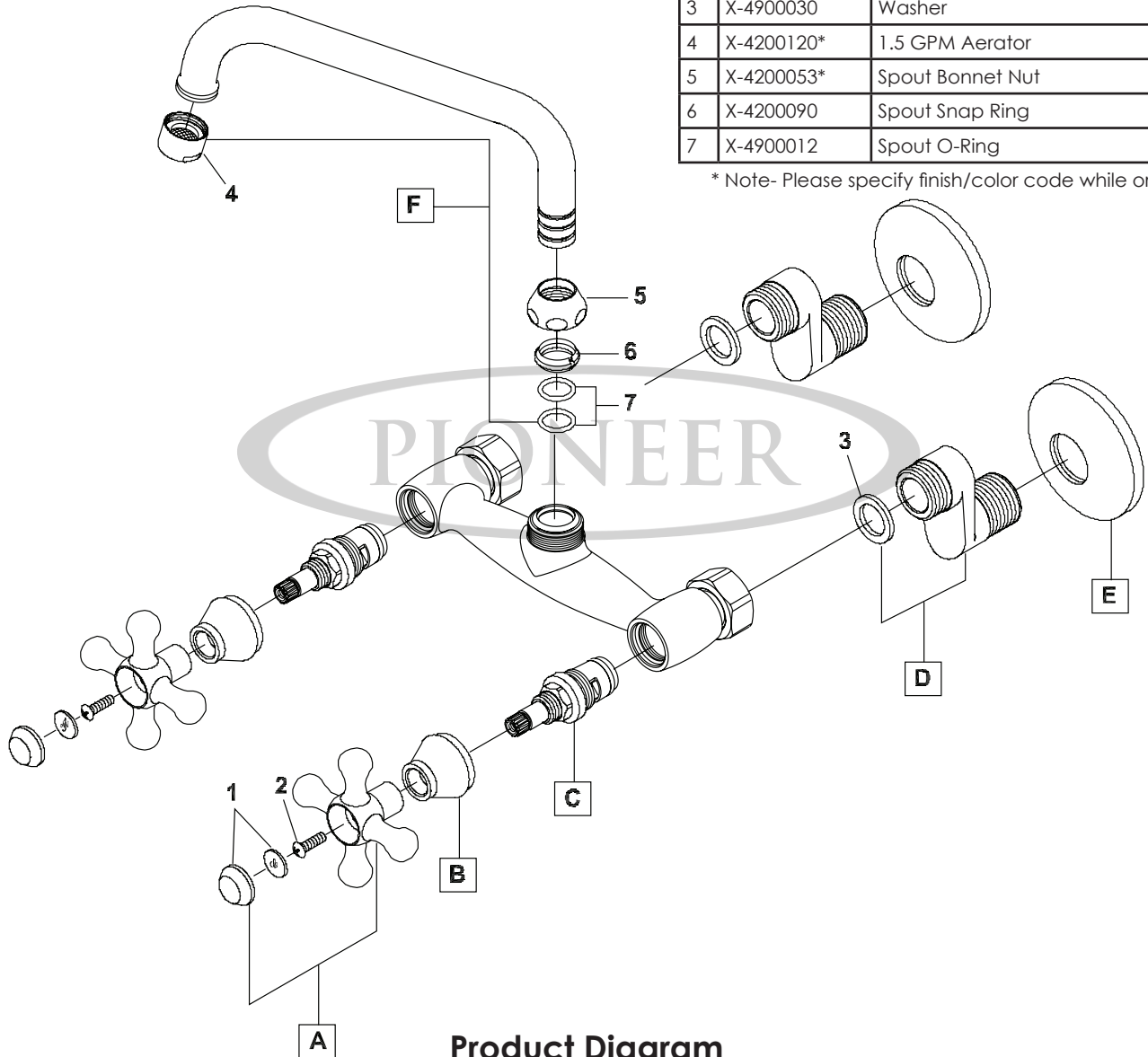

Product Diagram



ENGINEERING EXCELLENCE

Pioneer:1-800-338-9468  
 Commerce, CA 90040  
 www.pioneerind.com  
 Pioneer Industries, Inc. © 2013