



ENGINEERING EXCELLENCE

Motegi Series #4MT720

PARTS BREAKDOWN SHEET

DESCRIPTION

- Single Handle Roman Tub Set
- Metal Lever Handle
- Rigid Gooseneck Spout
- 9-3/8" Reach
- Ceramic Disc Cartridge with Temperature Limit Stop
- 2-Hole 4" to 6" Installation

FINISHES

- PC PVD Polished Chrome
- BN PVD Brushed Nickel
- SS PVD Stainless Steel
- PN PVD Polished Nickel
- PB PVD Polished Brass



#4MT720 SHOWN * ADA 

STANDARDS APPLICABLE

- ASME A112.18.1
- ANSI A117.1
- CUPC / IAPMO LISTED / ADA COMPLIANT

Note:-

Rough-in valve included.

Model #: _____

Specific Features: _____

Project Name: _____

Submitted For: _____

Model	Description	Finishes	
#4MT720	Single Handle Roman Tub Set	<input type="checkbox"/> PC	<input type="checkbox"/> Other__



ENGINEERING EXCELLENCE

Pioneer: 1-800-338-9468
 Commerce, CA 90040
 www.pioneerind.com
 Pioneer Industries, Inc. © 2013

DMPB4MT720/REV. 12 2012
 Page 1 of 2

	ITEM#	DESCRIPTION
A	X-1400005*	Motegi Series Handle
B	X-4400032*	Retainer Sleeve
C	X-4200035	Retainer Nut
D	X-3200001	Ceramic Disc Cartridge
E	X-4900004	Supply Nut
F	X-4400035*	Spout & Handle Escutcheon
G	X-5900002	Mounting Kit
H	X-4400029	Tee Connector
I	X-4900025	Cap & Washer
J	X-5400001	Spout Mounting Kit
K	X-5400005	Shank and Test Plug
L	X-2400018*	Motegi Gooseneck Spout
1	X-4900044*	Hole Cover
2	X-4900002	Allen Screw
3	X-4400036*	Flow Streamer
4	X-4900044*	Hole Cover
5	X-4400024	3/32" Allen Screw
6	X-4900026	Allen Wrench

* Note: Please specify finish/color when ordering.

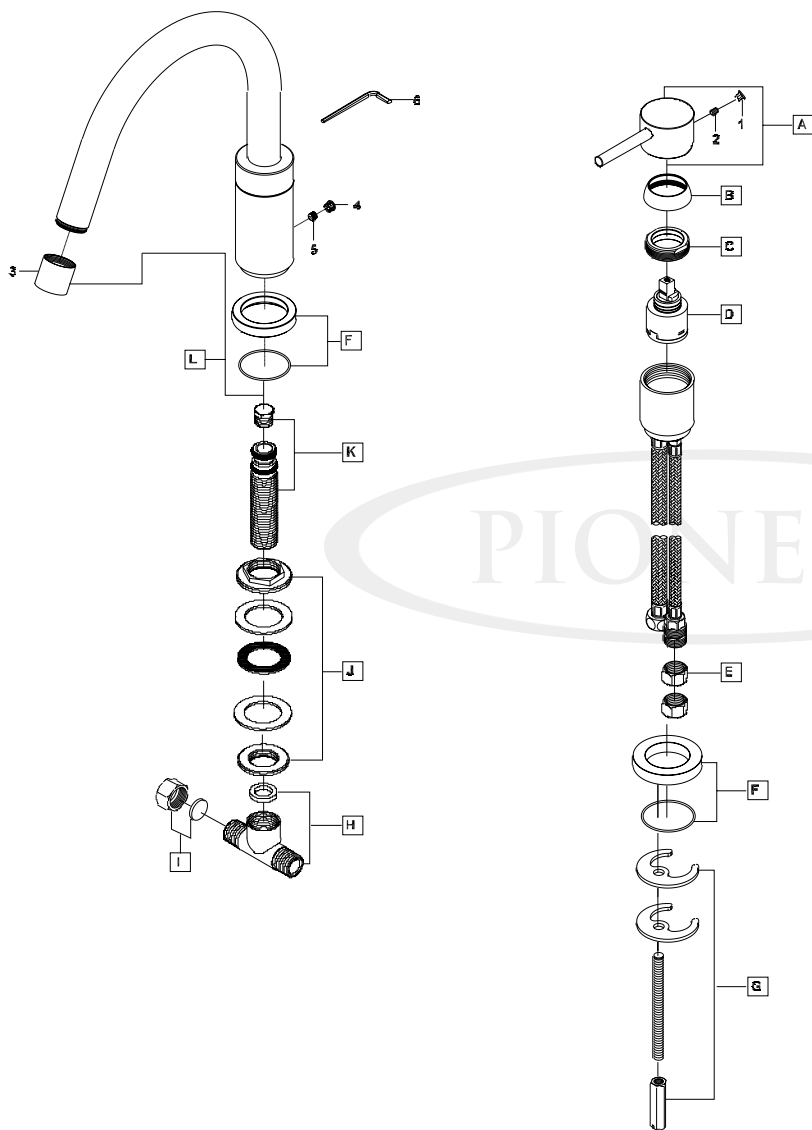

Product Diagram



ENGINEERING EXCELLENCE

Pioneer: 1-800-338-9468
 Commerce, CA 90040
 www.pioneerind.com
 Pioneer Industries, Inc. © 2013