



ENGINEERING EXCELLENCE

Del Mar Series #2DM300

PARTS BREAKDOWN SHEET

DESCRIPTION

- Two Handle Kitchen Faucet
- Metal Lever Handles
- Gooseneck Spout Swivel 360°
- 8-1/16" Reach, 7-1/8" From Deck to Aerator
- Ceramic Disc Cartridges
- 3-Hole 8" Installation

FINISHES

- PC PVD Polished Chrome
- BN PVD Brushed Nickel
- PN PVD Polished Nickel
- ORB Oil Rubbed Bronze
- TB PVD Tuscany Bronze



STANDARDS APPLICABLE

- ASME A112.18.1
- ANSI A117.1
- ANSI / NSF 61, SECTION 9
- CUPC / IAPMO LISTED / ADA COMPLIANT
- CONTAINS NO MORE THAN 0.25% WEIGHTED AVERAGE LEAD CONTENT

FLOW

- Aerator Limited to 1.5 GPM

#2DM300 SHOWN * ADA 

Model #: _____

Specific Features: _____

Project Name: _____

Submitted For: _____

Model	Description	Finishes	
#2DM300	Two Handle Kitchen Faucet	<input type="checkbox"/> PC	<input type="checkbox"/> Other___



ENGINEERING EXCELLENCE

Pioneer: 1-800-338-9468
 Commerce, CA 90040
 www.pioneerind.com
 Pioneer Industries, Inc. © 2013

DMPB2DM300/REV. 12 2012
 Page 1 of 2

	ITEM#	DESCRIPTION
A	X-1200006*	Del Mar Kitchen Handle
B	X-4900007	Bonnet Nut
C	X-4200021*	Deck Plate
D	X-3900002C	Ceramic Stem - Cold
E	X-3900002H	Ceramic Stem - Hot
F	X-4200022	Base Plate
G	X-4900008	Mounting Kit
H	X-4900004	Supply Nut
I	X-2200004*	High Gooseneck Spout
1	X-4900002	Allen Screw
2	X-4200114*	1.5 GPM Aerator
3	X-4200020*	Spout Sleeve
4	X-4900013	Spout Snap Ring
5	X-4900012	Spout O-Ring

* Note- Please specify finish/color code while ordering.

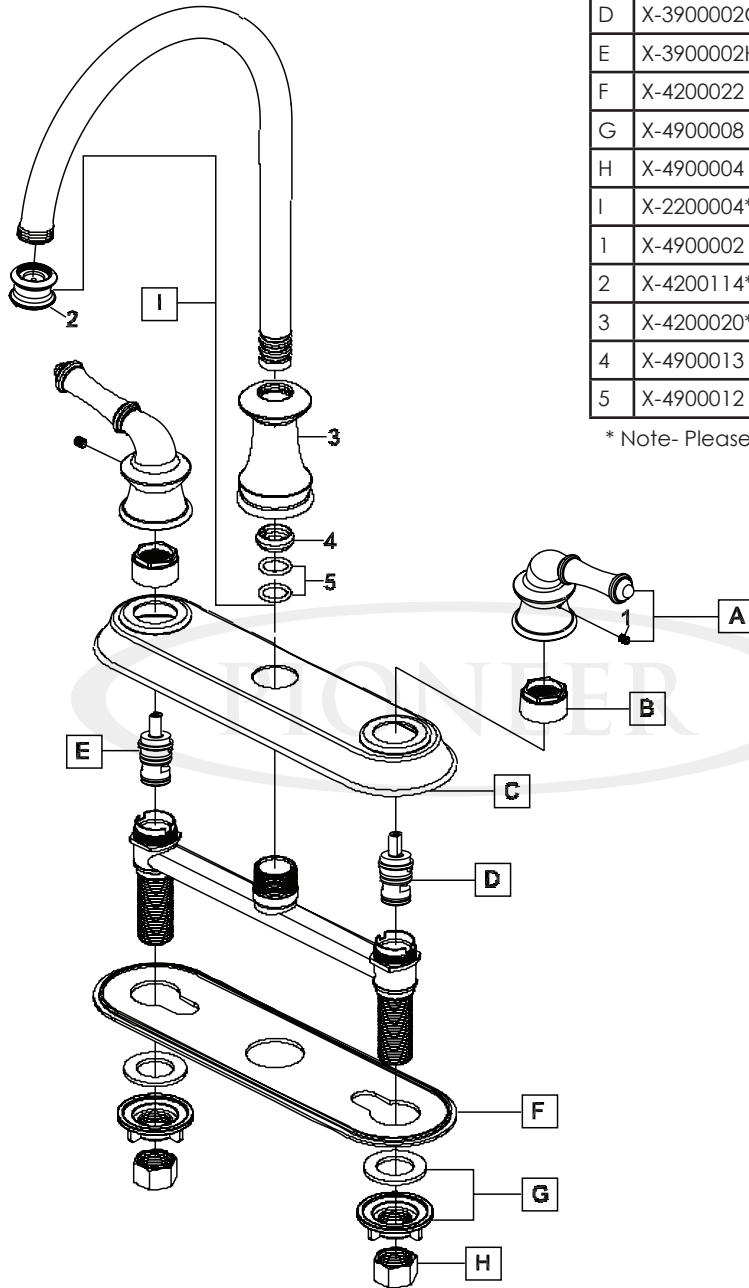

Product Diagram

