



ENGINEERING EXCELLENCE

Del Mar Series #2DM201

PARTS BREAKDOWN SHEET

DESCRIPTION

- Two Handle Kitchen Wide-spread Faucet
- Metal Lever Handles
- Gooseneck Spout Swivel 360°
- 8-1/16" Reach, 6-11/16" from Deck to Aerator
- Ceramic Disc Cartridges
- 4-Hole 6" to 16" Installation
- Side Spray Assembly

FINISHES

- PC PVD Polished Chrome
- BN PVD Brushed Nickel
- PN PVD Polished Nickel
- ORB Oil Rubbed Bronze
- TB PVD Tuscany Bronze



#2DM201 SHOWN * ADA 

STANDARDS APPLICABLE

- ASME A112.18.1
- ANSI A117.1
- ANSI / NSF 61, SECTION 9
- CUPC / IAPMO LISTED / ADA COMPLIANT
- CONTAINS NO MORE THAN 0.25% WEIGHTED AVERAGE LEAD CONTENT

FLOW

- Aerator Limited to 1.5 GPM

Model #: _____

Specific Features: _____

Project Name: _____

Submitted For: _____

Model	Description	Finishes	
#2DM201	Two Handle Kitchen Widespread Faucet	<input type="checkbox"/> PC	<input type="checkbox"/> Other__



ENGINEERING EXCELLENCE

Pioneer:1-800-338-9468
 Commerce, CA 90040
 www.pioneerind.com
 Pioneer Industries, Inc. © 2013

DMPB2DM201/REV. 12 2012
 Page 1 of 2

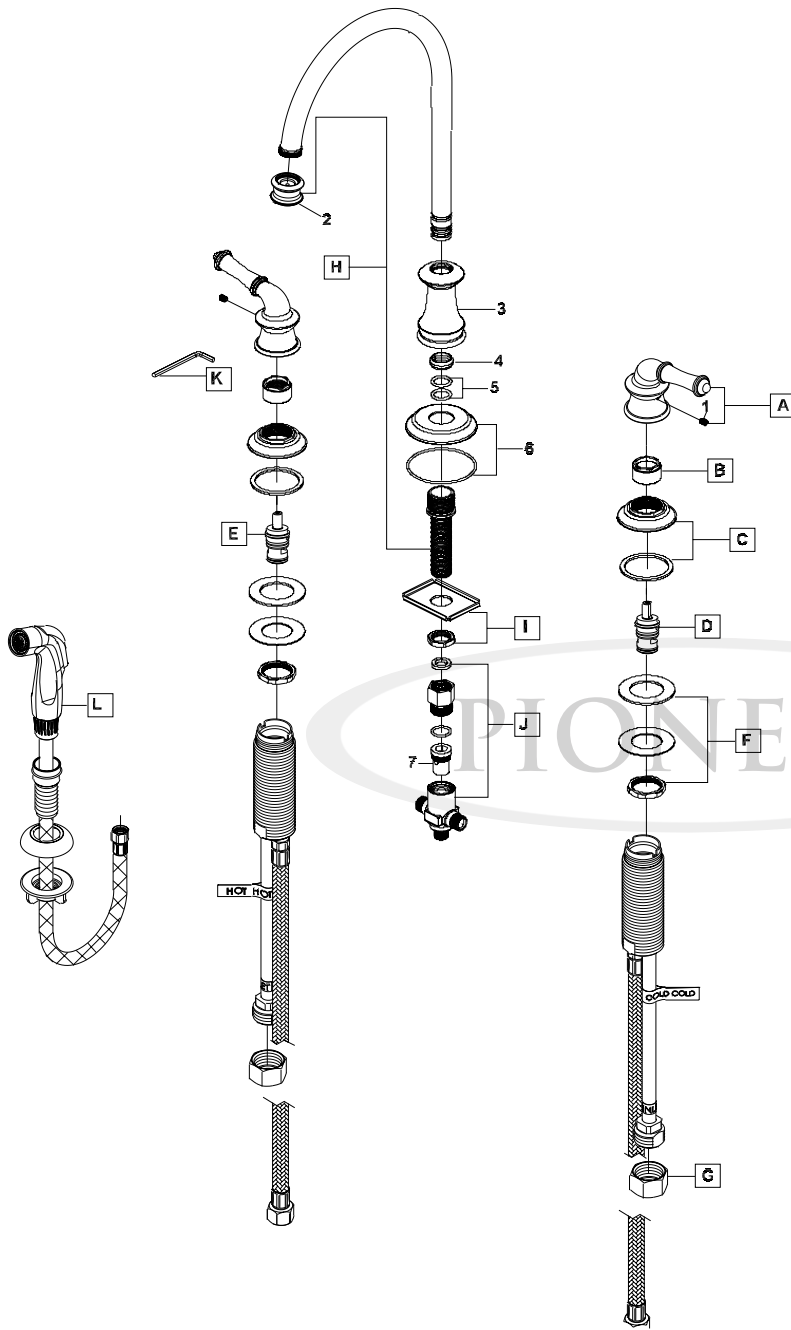

	ITEM#	DESCRIPTION
A	X-1200006*	Del Mar Kitchen Handle
B	X-4900022	Bonnet Nut
C	X-4900023*	Handle Escutcheon
D	X-3900002C	Ceramic Stem - Cold
E	X-3900002H	Ceramic Stem - Hot
F	X-5900001	Valve Mounting Kit
G	X-4900004	Supply Nut
H	X-2200005*	Del Mar High Gooseneck Spout
I	X-5200003	Spout Mounting Kit
J	X-4200025	Cross Connector
K	X-4900024	3/32" Allen Wrench
L	X-4200018*	Side Spray
1	X-4900002	Allen Screw
2	X-4200114*	1.5 GPM Aerator
3	X-4200020*	Spout Sleeve
4	X-4900013	Spout Snap Ring
5	X-4900012	Spout O-ring
6	X-4200023*	Spout Escutcheon
7	X-4200016	Diverter Piston

* Note- Please specify finish/color code while ordering.

Product Diagram



ENGINEERING EXCELLENCE

Pioneer: 1-800-338-9468
 Commerce, CA 90040
 www.pioneerind.com
 Pioneer Industries, Inc. © 2013