

Single Lever Handle Lavatory Faucet

Model Number:
UF368**

Features:

- Solid Brass Construction
- Single Hole Installation
- Drip Free Ceramic Cartridge
- Maximum flow rate 1.2 gpm at 60 psi
- Complies with:

NSF 61-9
ANSI / ASME A112.18.1
cUPC
IAPMO / UPC
CA AB-1953

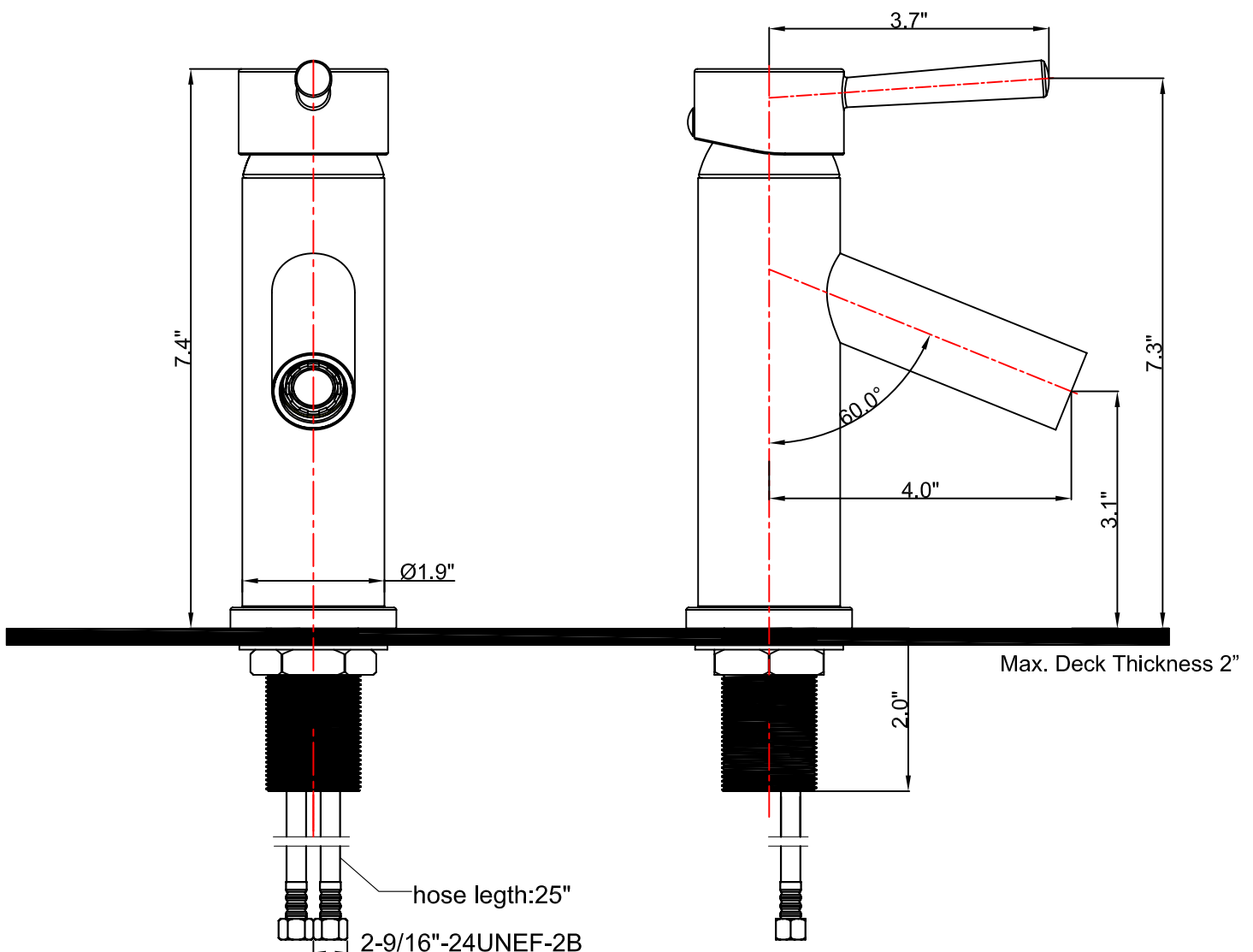
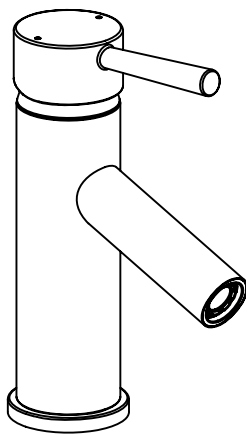

Thank you for choosing our product for your home. Your new faucet will give you years of trouble free performance. Please read all of these instructions carefully before installing your new faucet.

Model Number:
UF368**

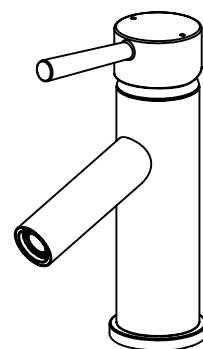

Useful Tools - For your safety and ease of installation, we recommend using the following tools

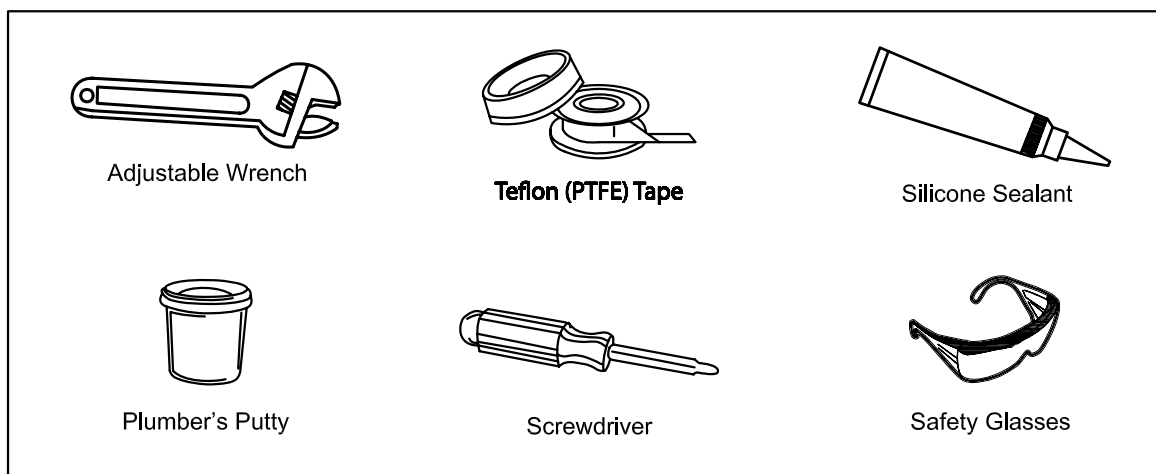

IMPORTANT POINTS

Wrap all threaded connections, except the aerator in the spout, with Teflon tape. Always wrap in a counter-clockwise direction. When installing your new faucet, first hand tighten the connection nuts then use a wrench to give the compression nut an additional (one) turn. Please do not over tighten the connection as it will reduce the integrity of the sealed connection.

Limited Five (5) Year Warranty

The manufacturer warrants to the original purchaser that this product to be free from defects in workmanship and materials during daily normal household use for a period of five (5) years. This warranty is non-transferable. Please keep a copy of the original invoice as proof of purchase.

Should a malfunction occur within the warranty period, Décor Star USA will, as its option, (1) repair or replace the defective part(s) or product at no charge; (2) issue a refund of the purchase price paid for the product (Valid within 30 days from the date of purchase); or (3) issue a credit to be applied against the purchase of a new Décor Star product. Shipping/delivery charges may apply and are in Décor Star USA's sole discretion.

This warranty shall not apply to goods which have been subject to accident, negligence, improper installation, product abuse, product misuse, or use of cleaners containing abrasives, alcohol or other organic solvents, whether performed by a contractor, service company, or yourself, are excluded from this warranty.

Our responsibility under this warranty is limited to only to replacement parts and no other costs. Décor Star USA will not be responsible for labor charges and/or damage incurred by installation, repair or replacement, nor for any indirect incidental or consequential damages, losses, injury or costs of any nature relating to this faucet. Except as provided by law, this warranty is in lieu of and excludes all other warranties, conditions, and guarantees, whether expressed or implied, statutory or otherwise, including

without restriction those merchantability of fitness for use.

This warranty covers the original consumer purchase only and does not include business, commercial or industrial use of this product. To obtain service under the Limited Warranty, please contact the Décor Star USA by www.decorstarusa.com. The Décor Star USA Customer Care Department will decide whether to repair or replace your product, issue a refund, or issue a credit.

Maintenance Guide

Please follow the cleaning material manufacturer's instructions. Damage caused by improper treatment will not be covered by product warranty. In addition, pay attention to the following points:

1. Regular cleaning can prevent mineral build up on faucet spout.
2. Carefully read the cleaner product label to ensure the cleaner is safe for use on the material.
3. Test the cleaner on a small area before using on the entire surface.
4. Use a mild detergent such as liquid dishwashing soap and warm water for cleaning.
5. Do not use abrasive / harsh chemical when cleaning the fixture as they will damage and dull the finish.
6. When using spray cleaners, spray first onto a soft cloth or sponge. Never spray directly onto the faucet as droplets can enter openings and gaps and cause damage.
7. After cleaning, rinse thoroughly with clean water to remove any cleaner residue.

Installation

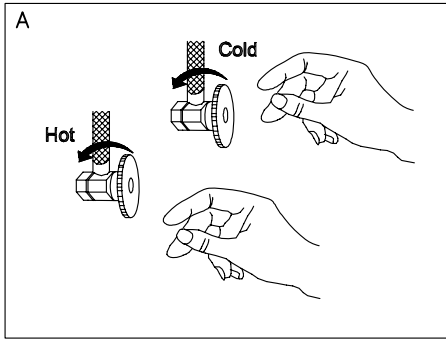

A. Shut off water supply at the valves. Remove old faucet and clean the mounting surface for installation of new faucet.

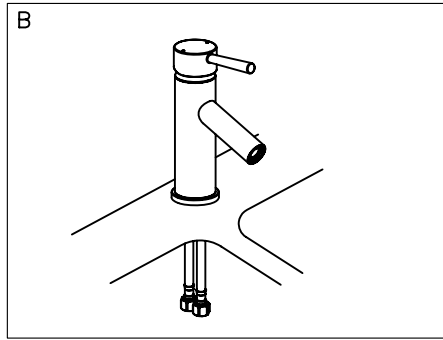

B. Place flange (11) and washer (12) under the new faucet. The faucet hole on the mounting surface should be 1 1/2" in diameter.

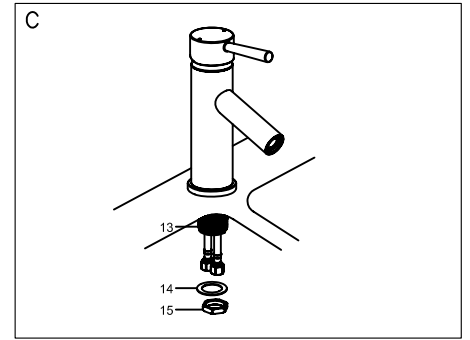

C. From under the sink, install the mounting tube (13) and nuts (15) onto the mounting tube (13). Tighten the nuts to secure the faucet to the mounting surface.

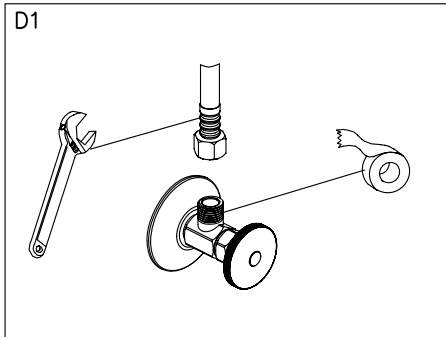

D1. Apply Teflon (TPFE) tape on the shut off valves. Thread the tape in counter-clockwise direction.

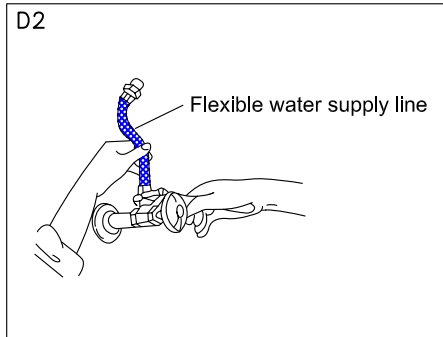

D2. Use Wrench to tighten the water supply hoses, please do not overtighten the connections.

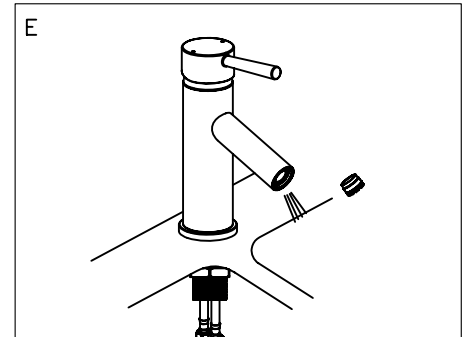

E. Turn on water supply to check for leaks at all connection. Remove aerator from the spout and let the water run for about 1 minute and check for leaks. Reattach the Aerator.

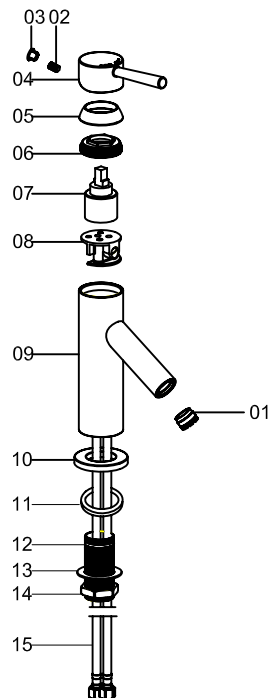

1. Aerator
2. Screw
3. Temperature Indicator
4. Handle
5. Cap
6. Bonnet
7. Cartridge
8. Body Seat
9. Body
10. Flange
11. Eva washer
12. Shank
13. Steel washer
14. Mounting nut
15. Hose