

19 271 VP0 KENSINGTON <P>2-WAY DIVERTER</P>



PRODUCT DESCRIPTION

- Corona handle
- set for final installation (for 29 712)
- without concealed body
- escutcheon with wall sealing
- screwable
- adjustable installation depth
- **GROHE StarLight** chrome finish
- for use with rough-in valve 29 712

19 271 VP0 **KENSINGTON <P>2-WAY DIVERTER</P>**

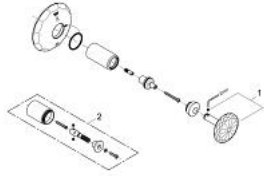

SPARE PARTS

- 1: Handle (Order-nr. 18089VP0)
- 2: Extension (Order-nr. 45979000)*
- * Optional accessories