

# FOOT ACTUATED TRIM KIT PARTS LIST

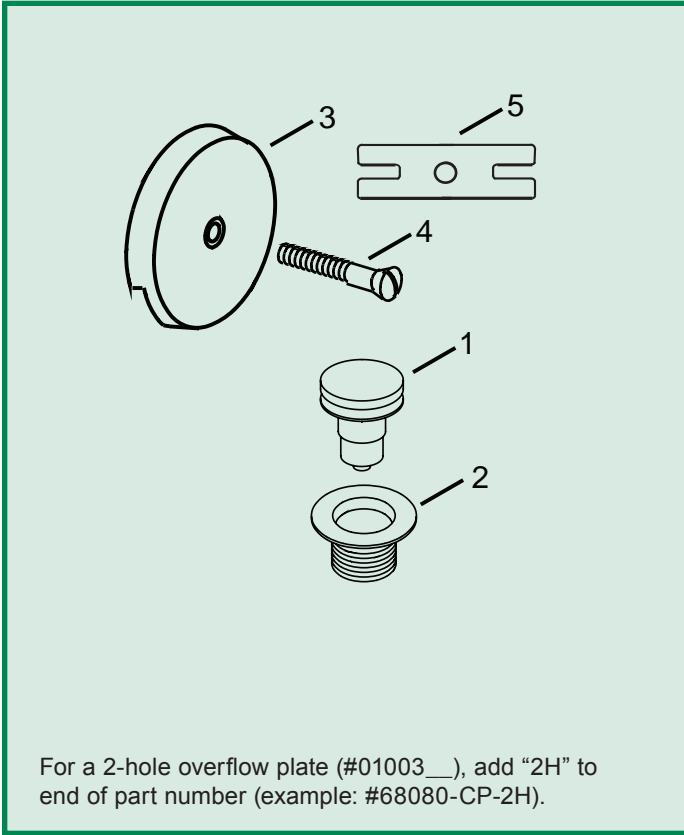

Item	Part #	Description
<b>WITH COARSE-THREAD (11.5) BODY:</b>		
1.	38412__....	Foot Actuated stopper
2.	01016__....	Strainer Body, Brass, CT: 1.865"-11.5-1.25"
3.	01002__....	1-Hole Overflow Plate, metal
4.	01024__....	Overflow Plate Screw, Brass, 2.25"
5.	11641 .....	Adapter Bar, aluminum
<b>WITH FINE-THREAD (16) BODY:</b>		
1.	38412__....	Foot Actuated stopper
2.	01022__....	Strainer Body, Brass, FT: 1.625"-16-1.25"
3.	01002__....	1-Hole Overflow Plate, metal
4.	01024__....	Overflow Plate Screw, Brass, 2.25"
5.	11641 .....	Adapter Bar, aluminum
__ Please indicate desired finish.		

## Finishes Available in the Foot Actuated Series:

Trim Kits:	68080	68190	68290	68390	68490
CP - Chrome Plated	•	•	•	•	•
AB - Antique Brass					
AP - Aged Pewter					
BB - Brushed Bronze					
BN - Brushed Nickel	•	•	•	•	
BO - Bone					
BS - Biscuit					
BZ - Oil-Rubbed Bronze	•	•	•	•	
CB - Chrome Brushed					
NP - Nickel Polished	•	•	•	•	
PB - Polished Brass	•	•	•	•	•
WH - White					
WI - Wrought Iron					



For More Information Contact:  
**WATCO Manufacturing Company**  
 1220 South Powell Road  
 Independence, MO 64057-2724  
 Ph. 816-796-3900 • FAX 816-796-0875  
[www.watcomfg.com](http://www.watcomfg.com)