

10

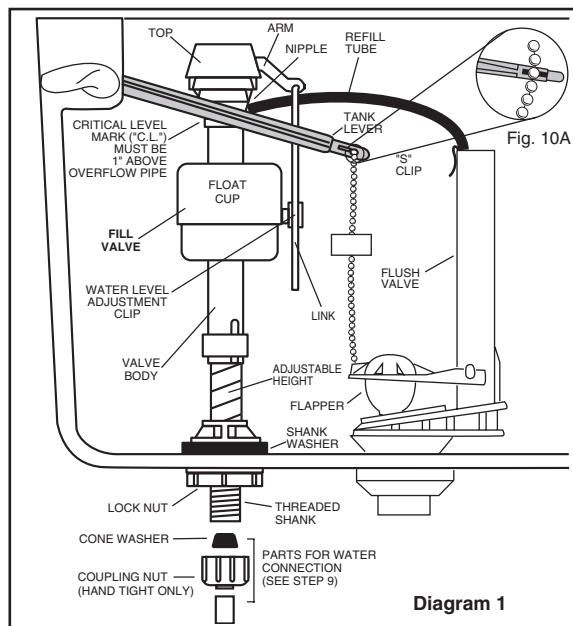

Diagram 1

ADJUSTMENTS

- a. Adjust water level. Water level should be adjusted to level indicated on tank by adjusting float cup.

See Step 11 for water level adjustment method

- b. If bowl fails to siphon, an adjustment may be required with the lift chain. Simply remove the bead chain from the retainment clip (see Fig. 10A) and take up slack on the chain, and reinsert on lift rod. Make sure the chain is not too taught.

11

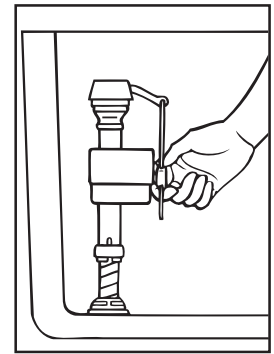

Turn on water supply. Adjust water to desired level by squeezing water level adjustment clip and moving FLOAT CUP up or down along stainless steel link.

12 CARE AND CLEANING

When cleaning your toilet, wash it with mild, soapy water, rinse thoroughly with clear water and dry with a soft cloth. Avoid detergents, disinfectants, or cleaning products in aerosol cans. NEVER use abrasive scouring powders or abrasive pads on your toilet seat. Some bathroom chemicals and cosmetics may damage the seat's finish.

WARNING: Do not use in-tank cleaners. Products containing chlorine (calcium hypochlorite) can seriously damage fittings in the tank. This damage can cause leakage and property damage.

American Standard shall not be responsible or liable for any tank fitting damage caused by the use of cleaners containing chlorine (calcium hypochlorite).

REPAIR PARTS LIST

Repair parts are determined by toilet tank number which can be found marked inside tank.

NOTE: "XXX" represents color or trim finish options. Specify when ordering.

PART NO.	DESCRIPTION	TANK NUMBER					
		4114 Cadet	4096 Ravenna	4111 Reminiscence	4110 Cadet	4112 Cadet	4656 Cadet
047242-XXX0A	TRIP LEVER	✓					
047192-XXX0A	TRIP LEVER				✓	✓	✓
730288-XXX0A	TRIP LEVER			✓			
738517-XXX0A	TRIP LEVER		✓				
738171-XXX0A	RIGHT HAND TRIP LEVER					✓	
034783-XXX0A	BOLT CAP KIT (INCL TWO COVERS & WASHERS)	✓	✓	✓	✓	✓	✓
738565-400.0070A	FLUIDMASTER 400A VALVE				✓	✓	
738565-401.0070A	FLUIDMASTER 400A VALVE	✓					
738565-402.0070A	FLUIDMASTER 400A VALVE			✓			
738565-404.0070A	FLUIDMASTER 400A VALVE		✓				
738138-0070A	FLUSH VALVE			✓			
738484-0070A	FLUSH VALVE				✓		✓
738360-0070A	FLUSH VALVE		✓			✓	
738361-0070A	FLUSH VALVE	✓					
738757-0070A	COUPLING KIT, KIT 242	✓	✓	✓	✓	✓	
738159-0070A	FLAPPER ASSEMBLY			✓			
738397-0070A	FLAPPER ASSEMBLY				✓		✓
738358-0070A	FLAPPER ASSEMBLY		✓			✓	
738359-0070A	FLAPPER ASSEMBLY	✓					
738565-418.0070A	FLUIDMASTER 400A VALVE						✓
730519-0070A	COUPLING KIT, BOWL-TO-TANK KIT 233						✓

American Standard

Replace the "YYY" with appropriate finish code

CHROME	002
WHITE	020
BLK. NICKEL/BRASS	062
BLACK SMITH (PVD)	078
POLISHED BRASS	099
SATIN/CHROME	221
SATIN NICKEL	295
SATIN/BRASS	297
CHROME/BRASS	299

AMARILIS LEXINGTON DECK-MOUNT BATH FILLER MODEL NUMBERS

8970 SERIES
8971 SERIES

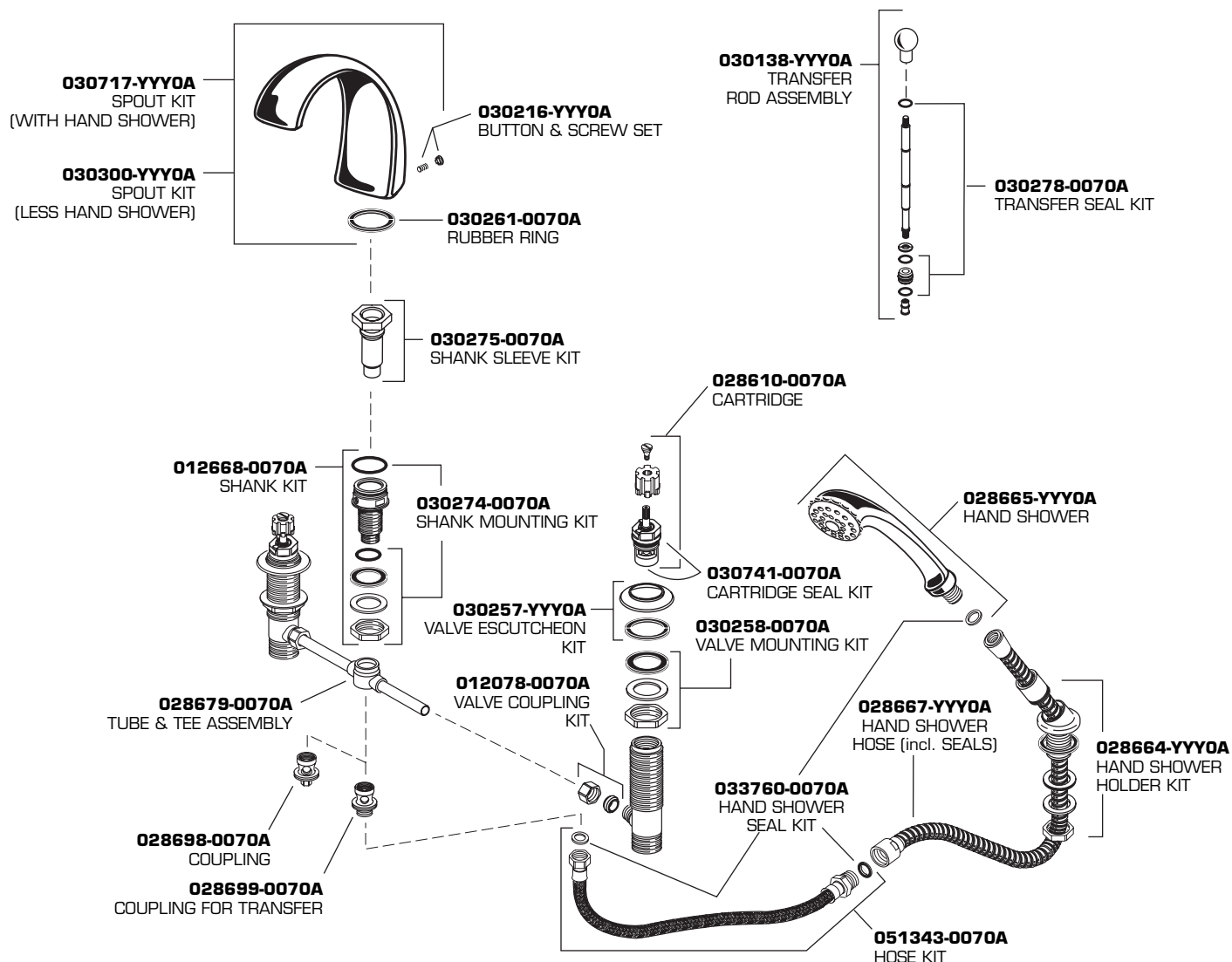

7

EverClean™ Finish Care Instructions

American Standard's EverClean finish will wipe clean with a soft, dry cloth. A soft cloth with clean water may also be used, if desired. No additional cleaning products are required.

DO NOT USE: Soaps, acid, polish, abrasives, harsh cleaners, or a cloth with a coarse surface.