

Submittal Data Sheet

SHR11004

Fantech Commercial Heat Recovery Ventilator Ducted Indoor Model

Features

- Premium aluminum cell
- Backward inclined motorized impeller
- Dual service doors & Reversible electrical box
- Push-pull configuration
- External electrical box
- Electrostatic filters
- External low voltage contacts
- Full length drain pan
- Outdoor ducts on the same side



Options & Controls

- MERV6 rated filters
- Compatible with all Fantech HRV controls.

Job Name:		
Job Location:		
Job Reference Number:		
Unit Reference Number:		
Engineer:		
Distributor:		
Contractor:		
For Reference:	For Approval:	For Construction:
Submitted by:		Date:
Address:		
Tel:	Fax:	Email:
Notes:		



United States · 1712 Northgate Blvd. · Sarasota FL 34234 · 1-800-747-1762 · www.fantech.net
Canada · 50 Kanalfakt Way. · Bouctouche, NB E4S 3M5 · 1-800-565-3548 · www.fantech.ca

Fantech, reserves the right to modify, at any time and without notice, any or all of its products features, designs, components and specifications to maintain their technological leadership position.

SHR11004 Submittal Data, Fantech Commercial Heat Recovery Ventilator

Descriptions

- Case:** 20 gauge G90 galvanized steel sheet coated with baked powder paint, insulated with 25mm (1 inch) fiberglass with FSK facing for condensation control.
- Blowers:** Four maintenance-free Ebm-Papst™ backward inclined motorized impellers with permanently lubricated sealed ball bearings and (TOP) thermal overload protected.
- Heat recovery core:** The heat recovery cores are fixed plate cross-flow heat exchanger using 1100 alloy aluminum and capable of transferring sensible heat between air streams. The heat recovery cores are engineered with a turbulence inducing geometry in order to maximize heat transfer while allowing an effective evacuation of condensate. The plates are hemmed to avoid cross-contamination of airstreams.
- Filters:** The exhaust and fresh air streams are protected by MERV1 washable filters constructed to meet UL Class2. Optional MERV6 filters are direct replacement to the MERV1. Use of MERV6 filters will add an additional system pressure of 70 Pa (0.28in.wg) at 519 l/s (1100cfm).
- Controls:** External three (3) position (Low / Standby / Medium) rocker switch that will offer continuous ventilation. Compatible with all Fantech HRV controls.
- Frost control:** A preset frost control sequence is initiated if the outdoor temperature falls below the set point of -5°C (23°F). During the initial stage, the supply blower shuts down & the exhaust blower switches into high speed to eliminate frost build-up in the core. The unit then returns to normal operation for the final stage of the frost control sequence at which time the sequence is repeated if the outdoor air temperatures is still below the set point.
- Serviceability:** Unit has hinged or screwed access panels on front and back. Cores, filters, drain pan & motors are serviceable from either sides of the unit. Fan assemblies are mounted on a removable sliding base. Heat recovery cores are mounted in slide-out rails for ease of inspection, removal and cleaning. Accessibility to the electrical box is maintained for any unit installation.
- Mounting:** Unit can be rod mounted or seated on a platform. Flanged connections are provided for suitable ductwork connections. Unit shall be adaptable for easy service of electrical components.
- Warranty:** The heat recovery ventilator is warranted to be free from defect in material, workmanship and all parts for a period of 3 years from the purchase date. The heat recovery core is warranted to be free from defects in material and workmanship for a lifetime period under circumstances of normal use.

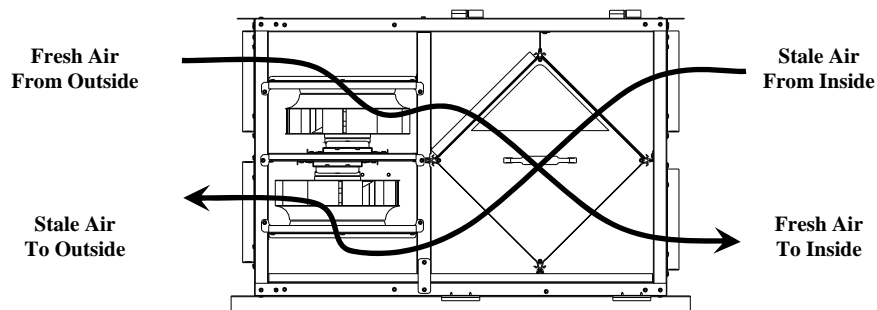

United States · 1712 Northgate Blvd. · Sarasota FL 34234 · 1-800-747-1762 · www.fantech.net
Canada · 50 Kanalfakt Way. · Bouctouche, NB E4S 3M5 · 1-800-565-3548 · www.fantech.ca

Fantech, reserves the right to modify, at any time and without notice, any or all of its products features, designs, components and specifications to maintain their technological leadership position.

SHR11004 Submittal Data, Fantech Commercial Heat Recovery Ventilator

Specifications

- Volts 120V
- Phase Single
- Amperage 10.8 Amps Total
- Blowers (x4) 115V, 60Hz, 2.7Amps



- Weight 110Kg (241Lbs)
- Shipping Weight 130Kg (286Lbs)
- Shipping Dim. 965x1346x686mm(38x53x27")

Airflow Performance

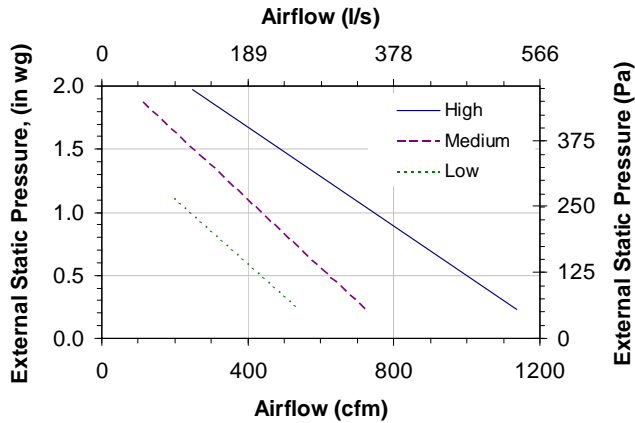

Thermal Effectiveness

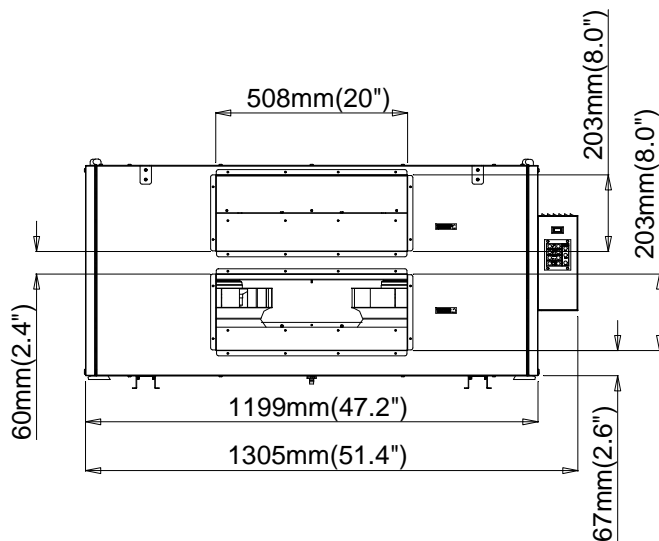
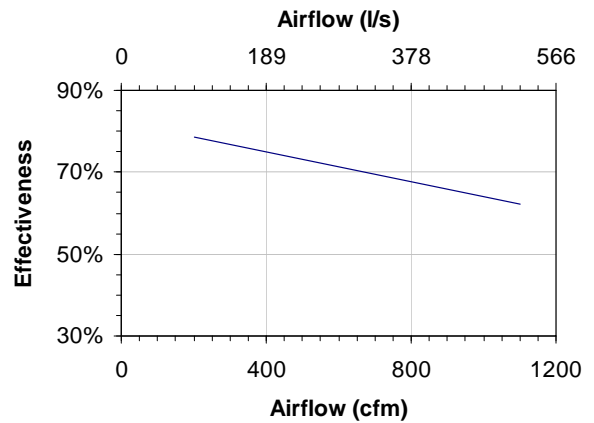

ELECTRIC BOX(can be relocated in the field to either the front or the back of the cabinet)

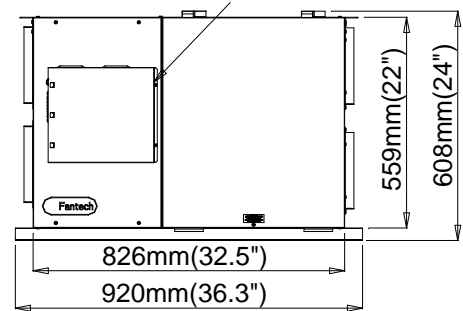

United States · 1712 Northgate Blvd. · Sarasota FL 34234 · 1-800-747-1762 · www.fantech.net
 Canada · 50 Kanalfakt Way. · Bouctouche, NB E4S 3M5 · 1-800-565-3548 · www.fantech.ca

Fantech, reserves the right to modify, at any time and without notice, any or all of its products features, designs, components and specifications to maintain their technological leadership position.