



# SERVICE PARTS LIST

**BULLETIN NO.**  
**54-26-2780**

SPECIFY CATALOG NO. AND SERIAL NO. WHEN ORDERING PARTS		REVISED BULLETIN	DATE
<b>M18™ FUEL™ 1/4" Hex Impact Driver (Wireless)</b>			Oct. 2015
CATALOG NO.	<b>2757-20</b>	STARTING SERIAL	<b>G80A</b>
		WIRING INSTRUCTION <b>SEE PAGE 2</b>	

**EXAMPLE:**  
00 | 0 Component Parts (Small #) Are Included  
When Ordering The Assembly (Large #).



**NOTE:** Components of Impacting Assembly (67) can drop out of gearcase (6). Care must be taken to hold these elements in place when assembling onto gearcase end cap (68).

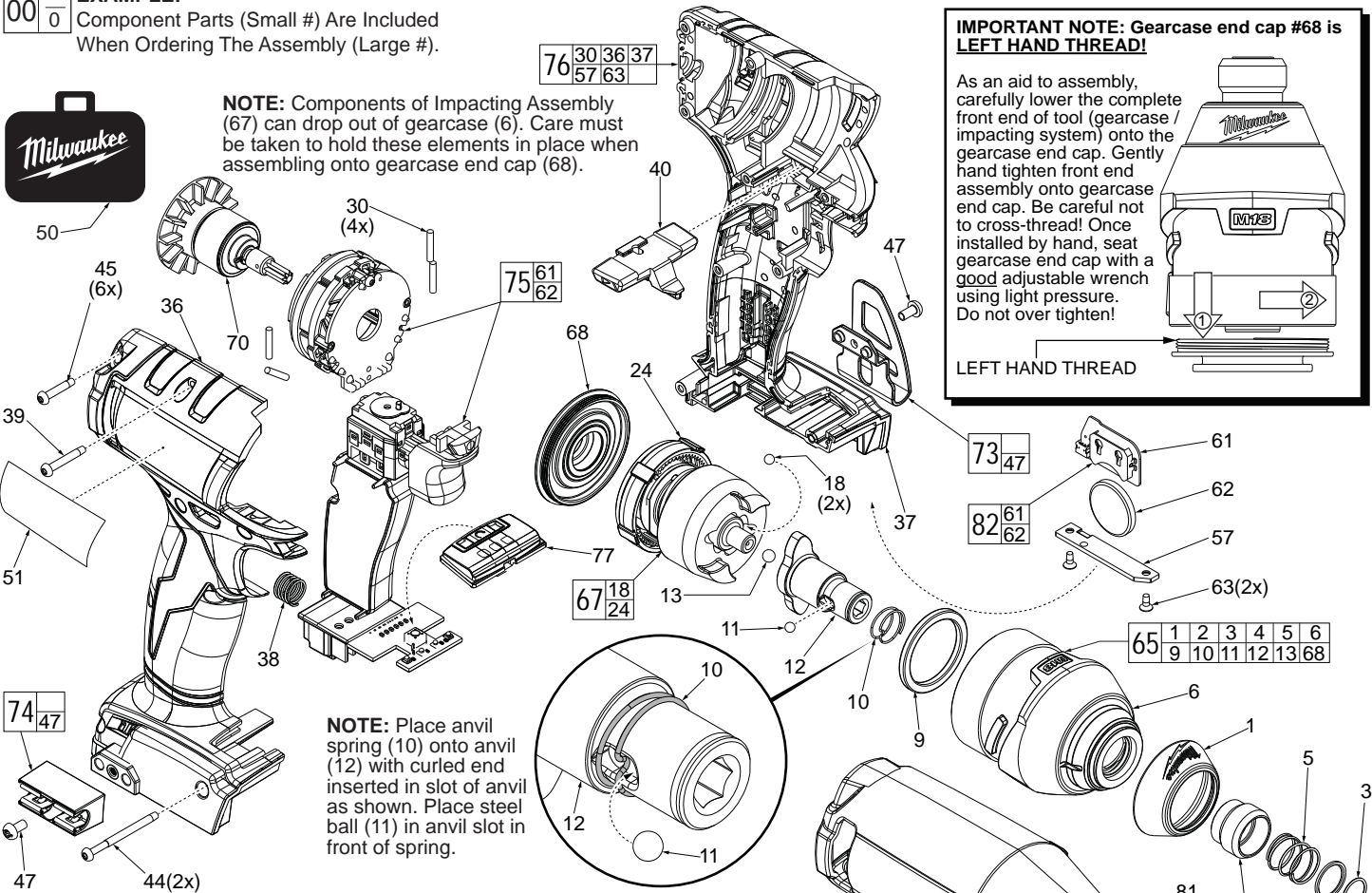

**IMPORTANT NOTE: Gearcase end cap #68 is LEFT HAND THREAD!**

As an aid to assembly, carefully lower the complete front end of tool (gearcase / impacting system) onto the gearcase end cap. Gently hand tighten front end assembly onto gearcase end cap. Be careful not to cross-thread! Once installed by hand, seat gearcase end cap with a good adjustable wrench using light pressure. Do not over tighten!

LEFT HAND THREAD

**NOTE:** Place anvil spring (10) onto anvil (12) with curled end inserted in slot of anvil as shown. Place steel ball (11) in anvil slot in front of spring.

FIG.	PART NO.	DESCRIPTION OF PART	NO. REQ.
1	31-12-0017	Rubber Cap	(1)
2	42-76-0019	Sleeve	(1)
3	34-60-0725	Retaining Ring	(1)
4	45-88-2025	Washer	(1)
5	40-50-1470	Spring	(1)
6	28-50-0013	Gearcase with Bushing	(1)
9	45-88-2653	Plastic Washer	(1)
10	40-50-0057	Anvil Spring	(1)
11	02-02-0170	4mm Steel Ball	(1)
12	42-06-0017	1/4" Hex Anvil	(1)
13	02-02-1300	5mm Steel Ball	(1)
18	02-02-0180	3/16" Steel Ball	(2)
24	-----	Ring Gear	(1)
30	45-30-0022	Rubber Slug	(4)
36	-----	Right Handle Halve	(1)
37	-----	Left Handle Halve	(1)
38	40-50-1090	Compression Spring	(1)
39	05-78-0355	M3 x 20mm Pan Hd. ST T-10 Screw	(1)
40	45-24-0013	Forward/Reverse Shuttle	(1)
44	06-82-0013	M3 x 38mm Pan Hd. ST T-10 Tamproof	(2)
45	06-82-7236	M3 x 16mm Pan Hd. ST T-10 Tamproof	(6)
47	06-82-0130	6-32 x 5/16" Pan Hd. T-15 Machine Scr.	(2)
50	42-55-0021	Blow Molded Carrying Case	(1)
51	12-20-0068	Service Nameplate	(1)
57	42-92-2757	Coin Cell Cover	(1)
61	-----	Coin Cell PCBA	(1)
62	50-11-0020	3V Coin Cell Battery (CR 2032)	(1)
63	05-81-1100	M2.6 x 6mm Phillips Screw	(2)
65	14-30-0012	Gearcase Assembly	(1)
67	14-46-0014	Impacting Assembly	(1)
68	44-66-0023	Gearcase End Cap with Ball Bearing	(1)
70	16-07-0012	Rotor Assembly	(1)
73	42-70-0059	Belt Clip Assembly	(1)

FIG.	PART NO.	DESCRIPTION OF PART	NO. REQ.
74	43-72-0046	Bit Holder Assembly	(1)
75	14-20-0014	Electronics Assembly Consisting of: On-Off Switch, PCBA, Stator, LED, HV Protection, Battery Connector Block, Coin Cell PCBA and Coin Cell	
76	31-44-0024	Housing Halve Assembly	(1)
77	45-24-0061	Speed Selector Assembly	(1)
81	49-12-0011	Rubber Boot (Optional, Accessory)	(1)
82	22-09-2757	Bluetooth PCBA with Battery	(1)

FIG.	LUBRICATION
11,12	Lightly coat front washer surface of anvil (12) with grease, place a dab in the ball slot of anvil and in needle bearing inside the anvil.
24,67	Lightly coat the I.D. of the ring gear (24) and the center of the planet gears of impacting assembly with grease.
6	Coat inside of bushing inside front gearcase with grease.
70	Coat pinion of rotor assembly (70) with grease.