



Moderate to high airflow square fans for various applications

- Versatile installation
- Operable in air stream temperatures up to 140°F
- UL-listed and AMCA Air & Sound Certified
- Comes with fan brackets for quick & easy installation
- 5-year warranty

Technical parameters

Nominal data	
Voltage (nominal)	120 V
Frequency	60 Hz
Phases	1~
Input power	547 W
Input current	4.4 A
Impeller speed	1,640 rpm
Air flow	max 2,514 cfm
Temperature of transported air	max 140 °F
Protection/Classification	
Enclosure class, motor	IP54
Insulation class	F
Dimensions and weights	
Rectangular, height, inlet	18 x 18 in.
Rectangular, width, inlet	18 x 18 in.
Rectangular, height, outlet	18 x 18 in.
Rectangular, width, outlet	18 x 18 in.
Weight	52.5 lb
Optional	
Duct connection type	Square
Motor type	AC
Material	Metal

Dimensions

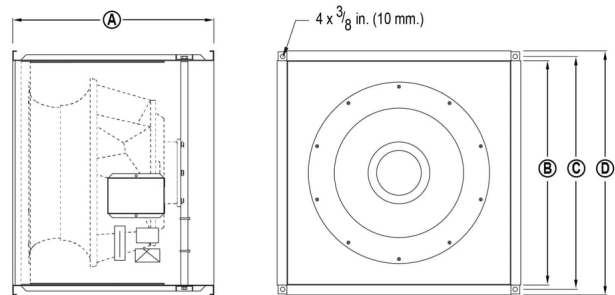

Model	A	B	C	D
FSD 18	15-3/4 (400)	17-19/32 (447)	18-5/8 (473)	19-39/64 (498)
FSD 20	17-23/32 (450)	19-23/32 (501)	20-49/64 (527)	21-23/32 (552)
FSD 22	19 (483)	21-5/8 (549)	22-21/32 (575)	23-39/64 (600)
FSD 26	20 (510)	26 (660)	27 (686)	28 (711)

Dimensions are in inches (mm).

Wiring

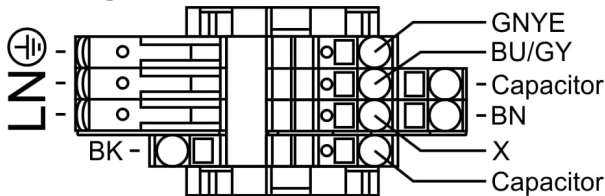

BU/GY - Blue or Grey BN - Brown
GNYE - Green-Yellow BK - Black

Performance curve

in. wg.

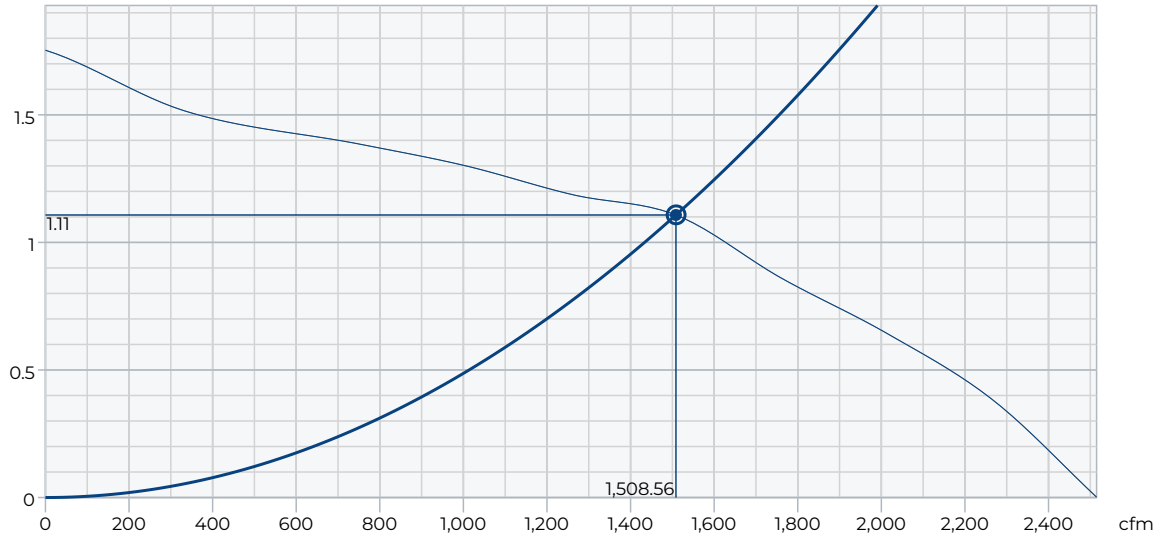

Performance data

Required air flow	1,509 cfm
Required static pressure	1.11 in. wg.
Working air flow	1,509 cfm
Working static pressure	1.11 in. wg.
Air density	0.075 lb/ft ³
Power	532 W
Fan control - RPM	1,609 rpm
Airflow efficiency	2.8 cfm/W
Supply voltage	115 V

Sound power level

		63	125	250	500	1k	2k	4k	8k	Total
Inlet	dB(A)	39	51	63	64	63	63	60	54	70

Documents

450375 FSD Submittal Sheet EN
 401618 FSD IOM EN
 FSD CSI Specification