



1000 Series Diverting Valve

V4044 LINE VOLTAGE

SUBMITTAL SHEET

APPLICATION

Use this valve in closed loop hydronic systems that do not contain dissolved oxygen in system water, such as fresh water from frequent source of makeup water. Valve designed for cycling (not constantly powered on) applications.

SPECIFICATIONS

Use: Hydronic Control

Type: 2 Position

Body Pattern: 3-Way, Diverting

Valve Action: Spring Return to Port A

Voltage: See V4044 Zone Valve Models on back

Power Consumption: 9.6 VA

Frequency: 60 Hz

De-energized Position: Port A Normally Closed

Maximum Ambient Temperature: 125 F (52 C)

Fluid Temperature Range: 40 F to 200 F (5 C to 93 C)

Nominal Timing: 30 sec.

Static Pressure: 125 Psi (862 kPa)

Warranty: 1 year limited warranty

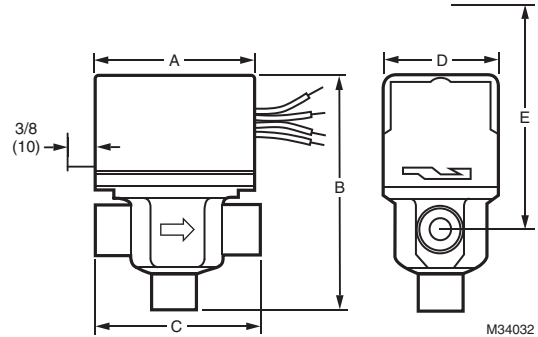

Dimensions

Product Number	Pipe Size	Type	Dimensions				
			A	B	C	D	E
V4044A1001	1/2"	Flare	3 1/2"	5 3/8"	4 11/16"	2 3/8"	5 1/4"
V4044A1019	1/2"	Sweat	3 1/2"	4 5/8"	3 1/8"	2 3/8"	5 1/4"
V4044A1035	1/2"	Sweat	3 1/2"	4 5/8"	3 1/8"	2 3/8"	5 1/4"
V4044A1043	1/2"	Flare	3 1/2"	5 3/8"	4 11/16"	2 3/8"	5 1/4"
V4044A1050	1/2"	Sweat	3 1/2"	4 5/8"	3 1/8"	2 3/8"	5 1/4"
V4044A1191	3/4"	Sweat	3 1/2"	4 13/16"	3 1/2"	2 3/8"	5 1/4"
V4044A1258	1/2"	Sweat	3 1/2"	4 5/8"	3 1/8"	2 3/8"	5 1/4"
V4044A1290	1/2"	Sweat	3 1/2"	4 5/8"	3 1/8"	2 3/8"	5 1/4"
V4044B1009	1/2"	Flare	3 1/2"	5 3/8"	4 11/16"	2 3/8"	5 1/4"
V4044B1017	1/2"	Sweat	3 1/2"	4 5/8"	3 1/8"	2 3/8"	5 1/4"
V4044B1314	3/4"	Sweat	3 1/2"	4 13/16"	3 1/2"	2 3/8"	5 1/4"

Maximum Close-Off Pressure & Capacity

Product number	Max Pressure		Capacity	
	Psi	kPa	Cv	Kv
V4044A1001	20	138	4	3.4
V4044A1019	20	138	4	3.4
V4044A1035	20	138	4	3.4
V4044A1043	20	138	4	3.4
V4044A1050	20	138	4	3.4
V4044A1191	10	69	7	6
V4044A1258	20	138	4	3.4
V4044A1290	20	138	2.7, 4	3.4
V4044B1009	20	138	4	3.4
V4044B1017	20	138	4	3.4
V4044B1314	10	69	7	6

Valve Materials

Body	Brass
Stem	Stainless Steel
Seat	Brass
Packing O-Ring	EPDM Rubber
Ball Plug	Buna-N (NBR) Rubber Ball

Actuator Materials

Case	Brass
Cover	Stainless Steel
Sector Gears	Brass

Job Name _____

Engineer _____

Mechanical Contractor _____

Contractor's P.O. No. _____

Representative _____

Notes _____

Model(s)

_____ Qty. _____ Notes _____

_____ Qty. _____ Notes _____

_____ Qty. _____ Notes _____

Approval _____

Service _____

Tag No. _____

BALL VALVE

The V4044 Zone Valves use a NBR rubber ball instead of a flange to create a seal. Using a ball versus the traditional flange provides a new sealing surface each time the valve operates, producing a quality seal and significantly increasing service life.

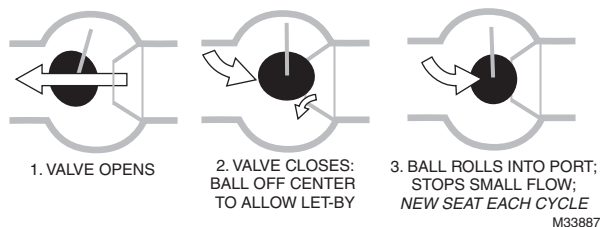

ADDITIONAL SPECIFICATIONS

Changeover Aquastat® Control: 120V, 3.0 A with 10.0 A inrush.

End Switch: 120 V, 4.4 A running with 26.4 A inrush (60Hz). Pilot duty 50 VA at 24 V.

Humidity Rating: 5-95% RH (non-condensing).

Atmosphere: non-corrosive, non-explosive.

Timing:

V4044: Divert flow in 30 seconds maximum.

Manual Opener: Manual opener (on all except the straight-through, normally open valves) allows opening the valve in case of power failure. Valve returns to automatic position when power is restored.

Approvals:

Underwriters Laboratories Inc. UL Component Listed: File MH11826 Vol. 1

MOUNTING

The valve can be mounted in any position on a vertical line. See the figure below. If the valve is mounted horizontally, the powerhead must be even with or above the center line of the piping. Make sure to leave enough room above the powerhead to remove the cover for servicing.

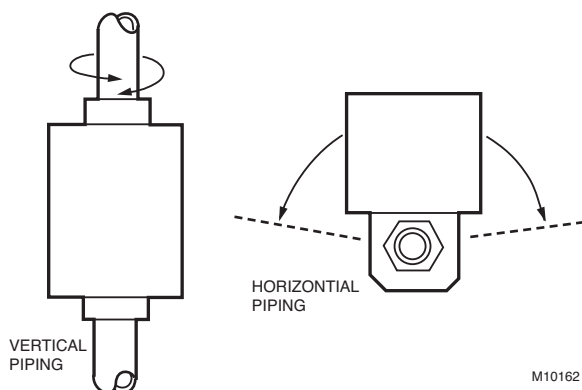

POWERHEAD REMOVAL

Converting the V4044 valve body for use with a new powerhead does not require removal of the valve body from the pipeline.

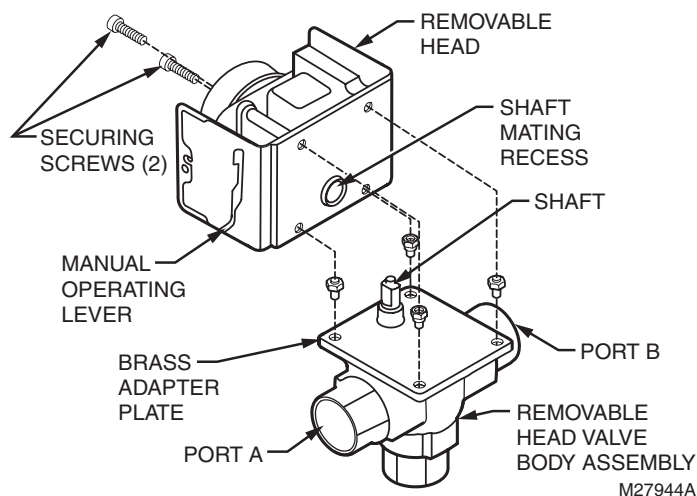

For Install instructions refer to literature number 95C-10442EF on Page 1.

V4044 Zone Valve Models

Connection Type	OS Number	Pipe Size		Voltage	Manual Opener	Electrical Connection
		Inch	DN			
Sweat	V4044A1019	1/2"	DN15	120 Vac	Yes	18 in. leads (457 mm leads)
	V4044A1035	1/2"	DN15	208 Vac	Yes	18 in. leads (457 mm leads)
	V4044A1050	1/2"	DN15	240 Vac	Yes	18 in. leads (457 mm leads)
	V4044A1191	3/4"	DN20	120 Vac	Yes	18 in. leads (457 mm leads)
	V4044A1258	1/2"	DN15	277 Vac	Yes	24 in. leads (610 mm leads)
	V4044A1290	1/2"	DN15	120 Vac	Yes	18 in. leads (457 mm leads)
	V4044B1017	1/2"	DN15	120 Vac	Yes	18 in. leads (457 mm leads)
	V4044B1314	3/4"	DN20	120 Vac	Yes	18 in. leads (457 mm leads)
Flare	V4044A1001	1/2"	DN15	120 Vac	Yes	18 in. leads (457 mm leads)
	V4044A1043	1/2"	DN15	240 Vac	Yes	18 in. leads (457 mm leads)
	V4044B1009	1/2"	DN15	120 Vac	Yes	18 in. leads (457 mm leads)